

**Instrument Regulator
Aluminum Model 1/4" Port Size**

- Compact instrument units with high performance
- Stable regulation with temperature compensation
- Excellent flow and regulation characteristics
- Panel Mounting facility



Ordering Information. Models listed are relieving type with 0.6 to 30 psig (0.04 to 2 bar) outlet pressure adjustment range *, and PTF threads. A gauge is not included.

Port Size	Model Number	Flow [†] scfm (dm ³ /s)	Weight lbs (kg)
1/4" PTF	R38-200-RNCA	17 (8)	1.06 (0.48)

† Typical flow with 100 psig (7 bar) inlet pressure, 15 psig (1 bar) set pressure and 1 psig (0.05 bar) droop from set.

R 3 8 - ★ ★ ★ - ★ ★ ★ ★			
Port Size	Substitute	Threads	Substitute
1/4" PTF	2	PTF	A
		ISO Rc taper	B
		ISO G parallel	D
		API.LP.INT	K
Material	Substitute	Outlet Pressure Adjustment Ranges*	Substitute
Aluminum, nitrile elastomers	0	0.6 to 30 psig (0.04 to 2 bar)	C
Aluminum, Viton elastomers	1	1 to 60 psig (0.07 to 4 bar)	F
		3.6 to 100 psig (0.25 to 7 bar)	K
Mounting Option	Substitute	Gauges	Substitute
Without	0	Without	N
With bracket and nut	1		
With panel nut only	2	Diaphragm	Substitute
With handwheel and nut	3	Relieving	R
With handwheel, bracket and nut	4	Non relieving	N
With handwheel only	5		

* Outlet pressure can be adjusted to pressures in excess of, and less than, those specified. Do not use these units to control pressures outside of the specified ranges.

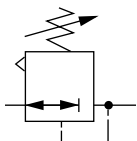
ISO Symbol

See Section ALE-24 for Accessories



Technical Data

Fluid: Compressed air

Maximum pressure: 290 psig (20 bar)

Operating temperature: -40° to 175°F (-40° to 80°C) *

* Air supply must be dry enough to avoid ice formation at temperatures below 35°F (2°C).

Typical flow at 100 psig (7 bar) inlet pressure, 15 psig (1 bar) set pressure and a droop of 1 psig (0.07 bar) from set: 17 scfm (8 dm³/s)

Typical relief differential at 30 psig (2 bar) outlet pressure:

2.3 psig (0.16 bar)

Maximum bleed flow at 30 psig (2 bar) outlet pressure (relieving types only):

0.003 scfm (1.5 cm³/s)†

† Maximum bleed rate occurs under dead-end (no flow) conditions.

Gauge ports:

1/4 NPT

Materials

Body: Aluminum

Bonnet: Aluminum

Adjusting screw: Steel

Elastomeric materials: Nitrile

Typical Performance Characteristics

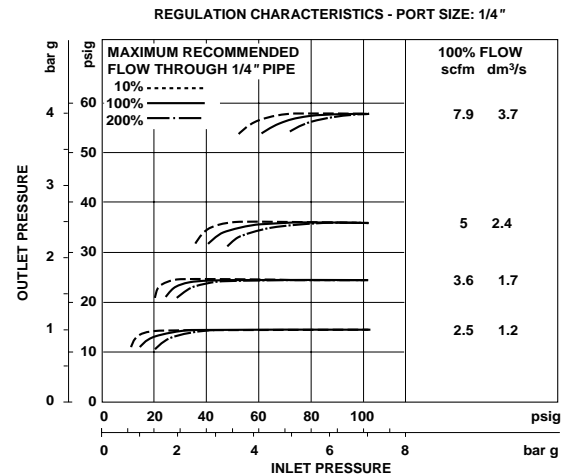
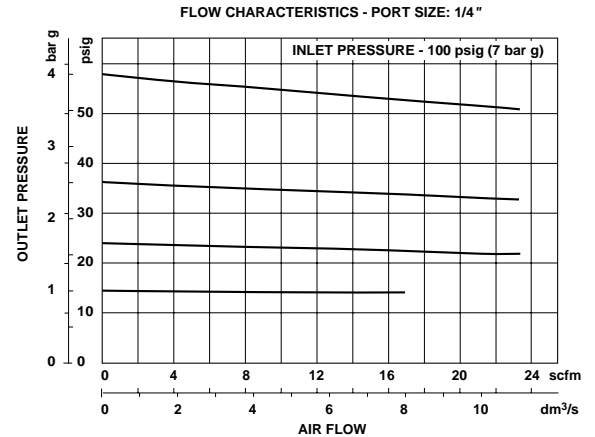

All Dimensions in Inches (mm)

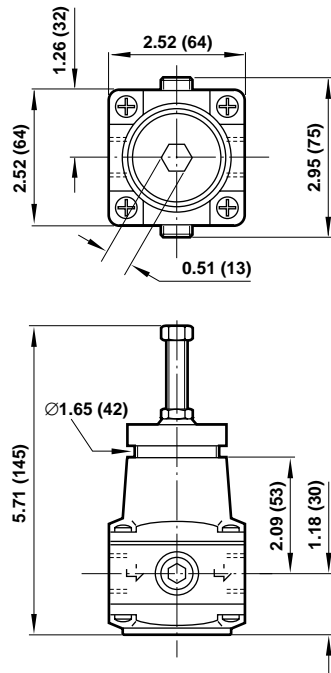

Panel mounting hole diameter: 1.65" (42 mm)
Panel thickness: 0" to 0.24" (0 to 6 mm)

Service Kits

Item	Type	Part number
30 psig (2 bar) Range	Relieving	R38-100-R
	Non relieving	R38-100-NR
60, 105 psig (4 bar, 7 bar) Range	Relieving	R38-101-R
	Non relieving	R38-101-NR

Service kit includes diaphragm assembly, o-ring, valve, valve spring and 8 pan head screws.