

- > **0 ... 12 bar**
Port size: G1/4
- > **Fast error detection via multi-colour display**
- > **Easy to use pressure switch with clear display and intuitive programming**
- > **Shock vibration tested to EN 61373, Category 1, class A and B**



Technical features

Medium:

Neutral gaseous and liquids, non-combustible

Operating pressure:

0 ... 12 bar (0 ... 174 psi)
(25 bar [362 psi] overloaded)

Port size:

G1/4

Supply voltage:

24 V d.c. (16,8 ... 32 V d.c.)

Switching current:

1,3 A (output 1)

Current consumption:

< 80 mA

Switching time:

≤ 5 ms

Switch output:

Short circuit protection

Hysteresis and repeatability

accuracy:

Programmable (option: preadjusted)

Accuracy:

≤ 2% FS* (incl. temperature drift)

Repeatability:

< ± 0,2% FS*

Linearity analogue port:

< ± 0,2% FS*

Switchlogic programmable:

NO/NC (pins can be individually programmed to NC or NO)

Display:

LED for switch status:
ON = green; OFF = red

Mounting position:

Optional

Electrical connection:

M12 x 1

Degree of protection:

IP67 acc to EN 60529
(with plug mounted)

Weight:

0,14 kg (0.30 lbs)

Temperature sensitivity:

< ± 0,2% FS*

Ambient/Media temperature:

-25 ... + 70°C (-13 ... 158°)

Air supply must be dry enough to avoid ice formation at temperatures below +2°C (+35°F)

* full scale

Materials:

Housing: Plastic

Sub-base: Aluminium

Connector (M12 x 1):

Nickel plated brass

Seals: FPM

Technical data

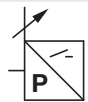
Symbol	Port size	Measuring range (relative pressure)		Model *1)
		(bar)	(psi)	
	G 1/4	0 ... 12	0 ... 174	G/61D-14-12-024-I

*1) Plug not in scope of delivery.

Accessories

Connector M12 x 1

4-pin, 90°



0523058
(2 m cable, 4-core)
0523053
(5 m cable, 4-core)

4-pin, straight



0523056
(without cable)
0523057
(2 m cable, 4-core)
0523052
(5 m cable, 4-core)
0523055 (without cable)

Electrical connection M12 x 1

	PIN-No.	Signal	Cable
	1	+UB 24 V d.c.	brown
	2	NC	white
	3	0 V (GND)	blue
	4	Out 1	black

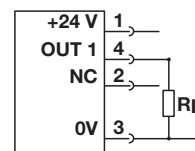

Dimensions

Dimensions in mm
Projection/First angle

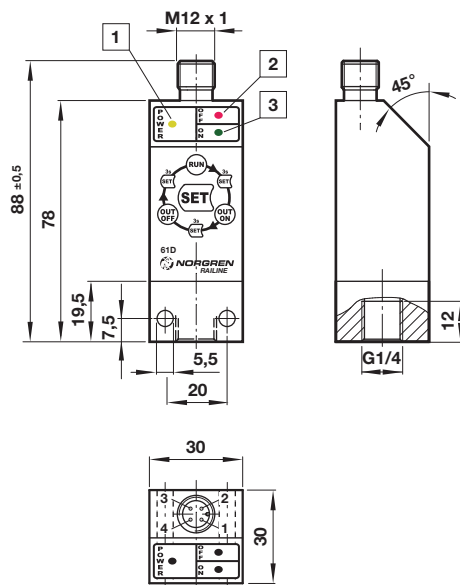

- 1 Status LED: yellow - Power on
- 2 LED red: OFF
- 3 LED green: ON

Warning

These products are intended for use in industrial compressed air and rail transport systems only. Do not use these products where pressures and temperatures can exceed those listed under

»Technical features/data«.

Before using these products with fluids other than those specified, for non-industrial applications, life-support systems, or other applications not within published specifications, consult NORGREN.

Through misuse, age, or malfunction, components used in fluid power systems can fail in various modes.

The system designer is warned to consider the failure modes of all component parts used in fluid power systems and to provide adequate safeguards to prevent personal injury or damage to equipment in the event of such failure.

System designers must provide a warning to end users in the system instructional manual if protection against a failure mode cannot be adequately provided.

System designers and end users are cautioned to review specific warnings found in instruction sheets packed and shipped with these products.