

- > Port size: 3/8" ... 3/4" (ISO G/NPT)
- > Excelon design allows in-line installation or modular installation with other Excelon products
- > Push to lock adjusting knob with tamper resistant accessory
- > Helps protect air operated equipment from over pressurisation
- > Wide temperature range
- > Shock and vibration tested to EN 61373, Category 1, class A and B

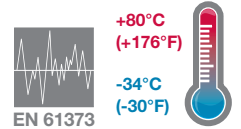

Technical features

Medium:

Compressed air only

Maximum operating pressure:

20 bar (300 psi)

Relief pressure range:

0,3 ... 10 bar (4 ... 145 psi)

Port size:

G3/8, G1/2, G3/4,
3/8 PTF, 1/2 PTF or 3/4 PTF

Gauge port:

Rc 1/8 with ISO G main ports
1/4 PTF with PTF main ports

Relief port:

Same size as the inlet port

Ambient/Media temperature:

-34 ... +80°C (-30 ... +176°F)

Version with gauge:
-34 ... +65°C (-30 ... +149°F)

Air supply must be dry enough to avoid ice formation at temperatures below +2°C (+35°F).

Materials:

Body & bonnet: aluminium
Valve: aluminium and NBR
Elastomers:
NBR and CR
Bottom plug: acetal

Technical data - standard models

Symbol	Port size	Size	Relief pressure (bar)	Weight		Model
				(kg)	(lbs)	
	G3/8	—	0,3 ... 10	0,82	1,8	LV74G-3GK-NMN
	3/8 PTF	—	0,3 ... 10	0,82	1,8	LV74G-3AK-NMN
	G1/2	Basic	0,3 ... 10	0,82	1,8	LV74G-4GK-NMN
	1/2 PTF	Basic	0,3 ... 10	0,82	1,8	LV74G-4AK-NMN
	G3/4	—	0,3 ... 10	0,78	1,7	LV74G-6GK-NMN
	3/4 PTF	—	0,3 ... 10	0,78	1,7	LV74G-6AK-NMN

Option selector

LV74G-***-NMN

Port size	Substitute
3/8"	3
1/2"	4
3/4"	6

Adjustment	Substitute
Knob (standard)	K
T-bar	T
Thread form	Substitute
PTF	A
ISO G parallel	G

Flow characteristics





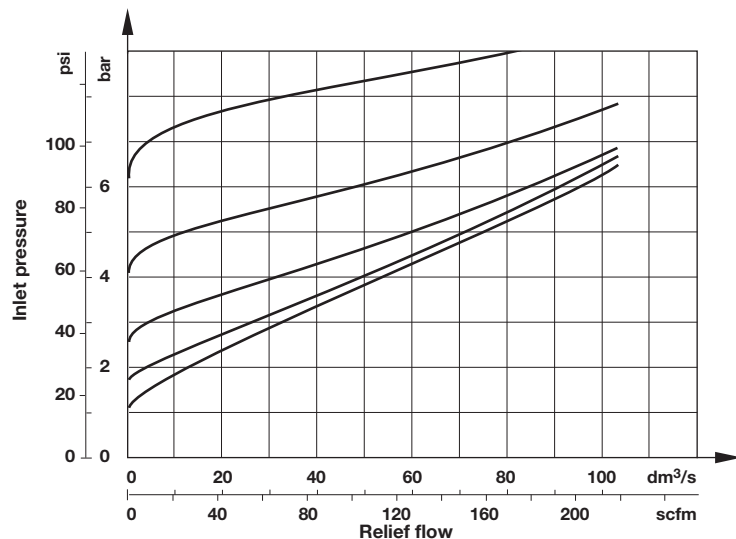

Spring range: 0,3 ... 10 bar (4 ... 145 psi)

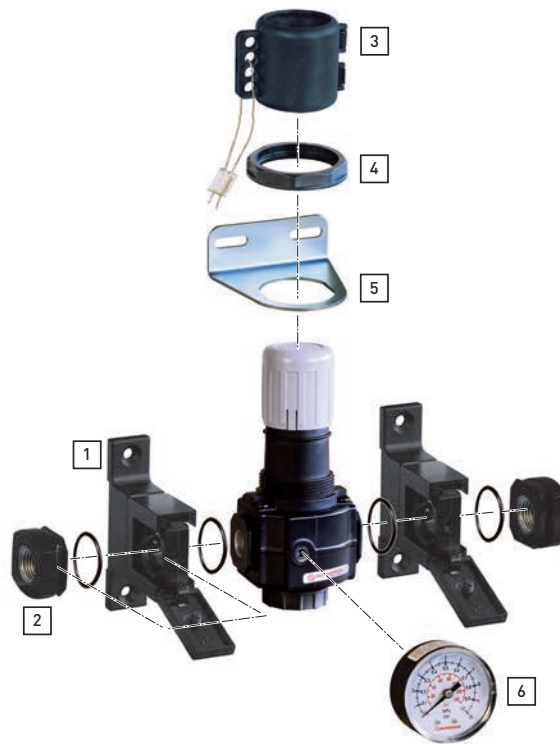
Port size: 1/2"



Accessories



Quikclamp®	Quikclamp with wall bracket® *1)	Neck mounting bracket	Panel nut	Tamper resistant kit	Quikmount pipe adaptor
					
1	1	5	4	3	2
Page 3	Page 3	Page 3			Page 3
4314-62	4314-63	4368-51	4348-89	4355-51	G3/8: 4315-10 G1/2: 4315-11 G3/4: 4315-12 3/8 PTF: 4315-02 1/2 PTF: 4315-03 3/4 PTF: 4315-04

Service kits

Service kit
4384-703

Gauge

Center back connection, white face (for full technical specification see datasheet 8.900.900)

6

Pressure range	bar *1	Mpa	psi	Ø	Thread size	Model
0 ... 10	0 ... 1	0 ... 145	50 mm	R1/8	18-015-013	

*1) primary scale

Center back connection, black face for North America (for full technical specification see datasheet 8.900.900)

6

Pressure range	psig *1	bar	Mpa	Ø	Thread size	Model
0 ... 160	0 ... 11	0 ... 1.1	2" (50 mm)	1/4 NPT	18-015-209	

*1) primary scale

Drawings
Standard
T-bar

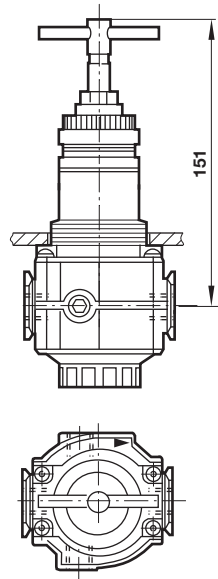
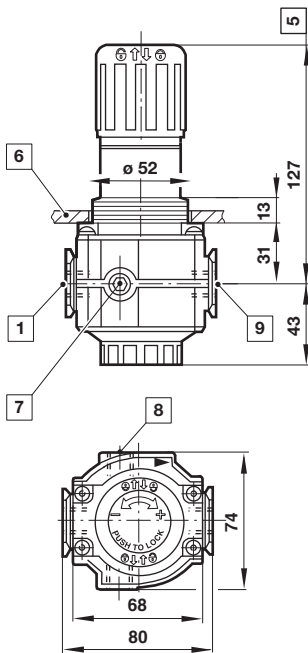
 Dimensions in mm
 Projection/First angle

- 1 Inlet ports 3/8", 1/2" or 3/4"
- 5 Reduces by 4 mm with knob in locked position
- 6 Panel thickness 2 ... 6 mm
- 7 Gauge port Rc1/8 for ISO G and 1/4 PTF for PTF main ports
- 8 Alternative gauge port plugged
- 9 Exhaust ports 3/8", 1/2" or 3/4"

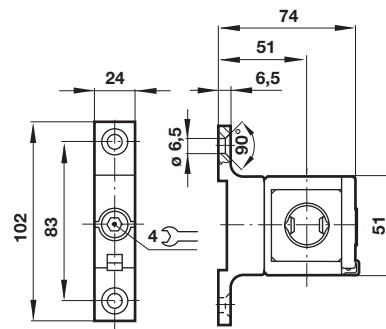
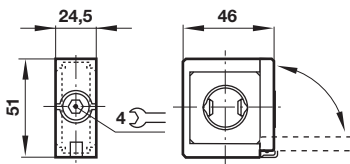
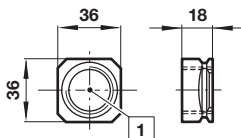
Accessories
Quikclamp®
Quikclamp® with wall bracket

Pipe adapter

- 1 Main ports 3/8", 1/2" or 3/4"
ISO G/PTF

Warning

These products are intended for use in industrial compressed air and rail transport systems only. Do not use these products where pressures and temperatures can exceed those listed under

»Technical features/data«.

Before using these products with fluids other than those specified, for non-industrial applications, life-support systems or other applications not within published specifications, consult IMI Precision Engineering, Norgren Inc.

Through misuse, age, or malfunction, components used in fluid power systems can fail in various modes.

The system designer is warned to consider the failure modes of all component parts used in fluid power systems and to provide adequate safeguards to prevent personal injury or damage to equipment in the event of such failure.

System designers must provide a warning to end users in the system instructional manual if protection against a failure mode cannot be adequately provided.

System designers and end users are cautioned to review specific warnings found in instruction sheets packed and shipped with these products.