

# M/55900

## Air/ Oil Pressure Converter



- > Volume: 0,25 ... 5 dm<sup>3</sup>
- > Corrosion resistant construction
- > Basic module to convert pneumatic pressure into hydraulic pressure
- > Integrated oil level indicator
- > Simple to install



### Technical features

#### Medium:

Compressed air, filtered, lubricated or non-lubricated

#### Oil filling:

Mineralic hydraulic oils ISO VG 32 or ISO VG 46 according to DIN 51524

#### Installation:

Only vertical, oil port below

#### Operating pressure:

10 bar (145 psi) maximum

#### Volume:

0,25 ... 5 dm<sup>3</sup>

#### Note:

To calculate the volume of the pressure converter 50% must be added to the volume of the cylinder.

#### Operating temperature:

-20 ... +60°C max. (-4 ... +140 °F)  
Air supply must be dry enough to avoid ice formation at temperatures below +2°C (+35°F).

#### Materials:



Barrel: Anodised aluminium alloy  
End covers: Anodised aluminium alloy  
Baffle plates: Anodised aluminium alloy  
Fittings: Brass  
Screws and nuts: Zinc plated steel  
Oil level indicator: PA-tube  
Seals: NBR

### Option selector

M/559★★

Volumes (dm <sup>3</sup> )	Substitute
0,25	3
0,5	5
0,75	8
1	10
1,5	15
2	20
3	30
4	40
5	50

### Mountings

Model	A	C
		
	Page 2	Page 2
M/55903	QM/8032/35	QA/8040/21
M/55905	QM/8032/35	QA/8040/21
M/55908	QM/8032/35	QA/8040/21
M/55910	QM/8032/35	QA/8040/21
M/55915	QM/8032/35	QA/8040/21
M/55920	QM/8032/35	QA/8040/21
M/55930	QM/8050/35	QA/8063/21
M/55940	QM/8050/35	QA/8063/21
M/55950	QM/8050/35	QA/8063/21

## Basic dimensions

Dimensions in mm  
Projection/First angle

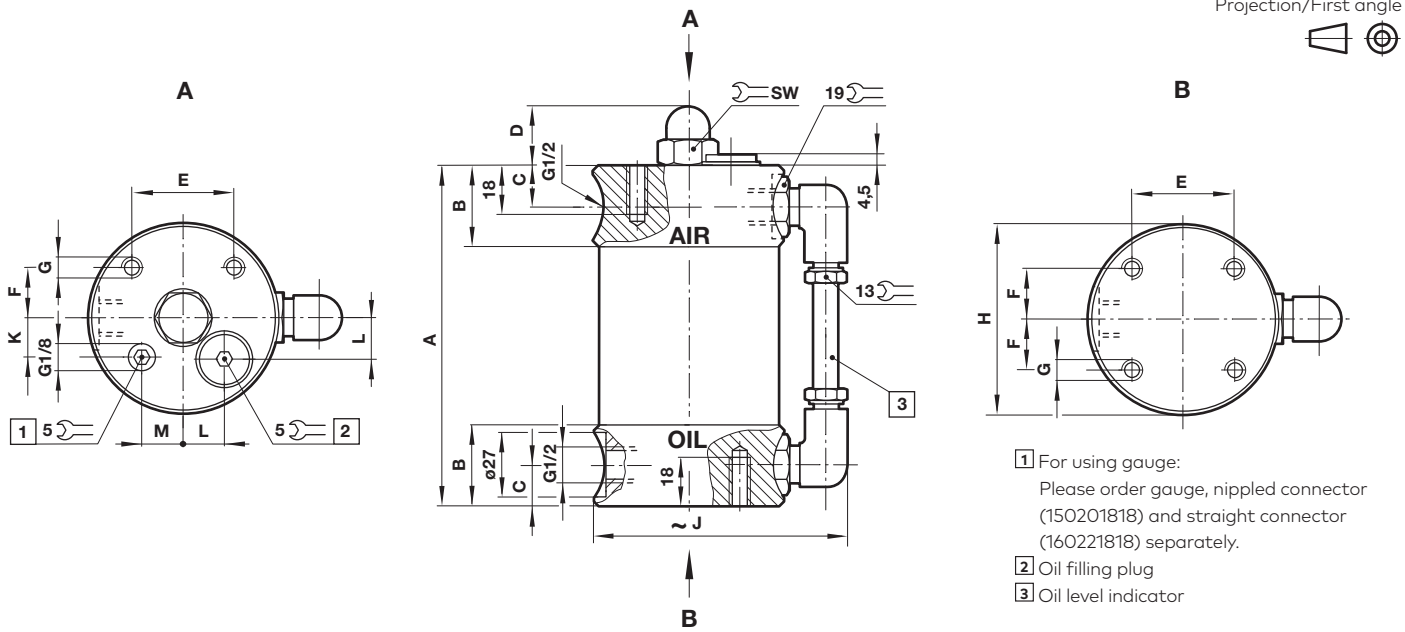

- 1 For using gauge:  
Please order gauge, nipped connector (150201818) and straight connector (160221818) separately.
- 2 Oil filling plug
- 3 Oil level indicator

A	B	C	D	E	F	G	Ø H	J	K	L	M	SW	Weight	Model
150	30	15	23	38	19	M 6	69	95	17	16	13	19	1,10 kg	M/55903
232	30	15	23	38	19	M 6	69	95	17	16	13	19	1,28 kg	M/55905
315	30	15	23	38	19	M 6	69	95	17	16	13	19	1,46 kg	M/55908
400	30	15	23	38	19	M 6	69	95	17	16	13	19	1,64 kg	M/55910
564	30	15	23	38	19	M 6	69	95	17	16	13	19	2,00 kg	M/55915
730	30	15	23	38	19	M 6	69	95	17	16	13	19	2,36 kg	M/55920
472	35	17,5	35	56,5	32,5	M 8	108	135	25	25	25	30	4,36 kg	M/55930
604	35	17,5	35	56,5	32,5	M 8	108	135	25	25	25	30	5,04 kg	M/55940
736	35	17,5	35	56,5	32,5	M 8	108	135	25	25	25	30	5,72 kg	M/55950

## Mountings

### Front or rear stud mounting A

Conforms to ISO 15552, type MX1

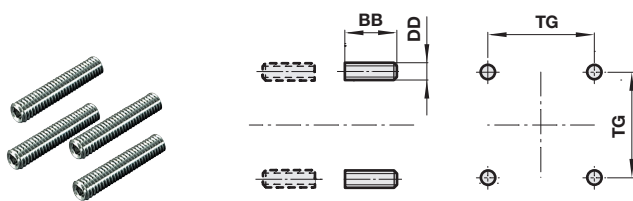

### Foot mounting C

Conforms to ISO 15552, type MS1

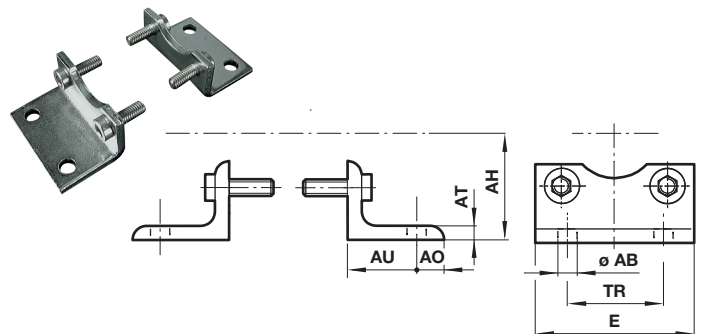

Volume	BB	DD	TG	kg	Model (A)
0,25 ... 2 dm <sup>3</sup>	17	M6	32,5	0,02	QM/8032/35
3 ... 5 dm <sup>3</sup>	23	M8	46,5	0,05	QM/8050/35

Volume	Ø AB	AH	AO	AT	AU	E	TR	kg	Model (C)
0,25 ... 2 dm <sup>3</sup>	10	36	9	4	28	53	36	0,18	QA/8040/21
3 ... 5 dm <sup>3</sup>	10	50	12	5	32	74	50	0,39	QA/8063/21

## Warning

These products are intended for use in industrial compressed air systems only. Do not use these products where pressures and temperatures can exceed those listed under »Technical features/data«.

Before using these products with fluids other than those specified, for non-industrial applications, life-support systems or other applications not within published specifications, consult Norgren.

Through misuse, age, or malfunction, components used in fluid power systems can fail in various modes.

The system designer is warned to consider the failure modes of all component parts used in fluid power systems and to provide adequate safeguards to prevent personal injury or damage to equipment in the event of such failure.

System designers must provide a warning to end users in the system instructional manual if protection against a failure mode cannot be adequately provided.

System designers and end users are cautioned to review specific warnings found in instruction sheets packed and shipped with these products.