

- > **Port size: DN 8 ... 50, G1/4 ... 2 (ISO G)**
- > **For fluids with high particle contamination**
- > **Fluid isolated from valve actuator**
- > **Optimised dimensions and weight**
- > **Vacuum version as an option**
- > **Compact valve for industrial applications**
- > **International approvals**

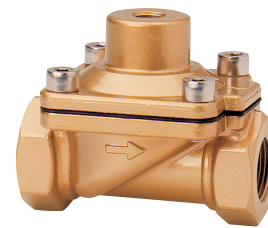

### Technical features

**Medium:**

Neutral fluids with high particle contamination

**Pilot fluid:**

Air max. +60°C (+140°F)

**Switching function:**

Normally closed with pilot pressure

**Operation:**

Externally actuated seat valves

**Type:**

Pressure actuated seat valve with diaphragm actuator

**Mounting position:**

Optional

**Flow direction:**

Determined

**Port size:**

G1/4, G3/8, G1/2, G3/4, G1, G1 1/4, G1 1/2, G2

**Pilot connection:**

G1/4

**Operating pressure:**

0,2 ... 16 bar

**Differential pressure:**

0,2 bar required

**Pilot pressure:**

G1/4 ... 1/2

max. 6 bar higher than operating pressure

G3/4 ... 2

max. 1 bar higher than operating pressure

**Fluid temperature:**

-10 ... +90°C (+14 ... +194°F)

**Ambient temperature:**

-10 ... +60°C (+32 ... +140°F)

**Viscosity:**

Max. to 80 mm<sup>2</sup>/s

**Material:**

Body: Brass (CW617N)

Cover: Brass (2.0402)

Seat seals: NBR

Internal parts: Brass, Stainless steel

Main sealing element:

Fabric reinforced NBR

diaphragm with valve plate

Valve seat: Brass

### Technical data - standard models

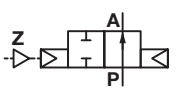
Symbol	Port size	Orifice (mm)	Pilot connection	Flow kv value *1) (m <sup>3</sup> /h)	Operating pressure *2) (bar) (psi)		Weight (kg)	Model
	G1/4	8	G1/4	1,7	0,2 ... 16	2,9 ... 232	0,5	8216000.0000.00000
	G3/8	10	G1/4	3,4	0,2 ... 16	2,9 ... 232	0,45	8216100.0000.00000
	G1/2	12	G1/4	4	0,2 ... 16	2,9 ... 232	0,4	8216200.0000.00000
	G3/4	20	G1/4	11	0,2 ... 16	2,9 ... 232	1,15	8216300.0000.00000
	G1	25	G1/4	13	0,2 ... 16	2,9 ... 232	1	8216400.0000.00000
	G1 1/4	32	G1/4	28	0,2 ... 16	2,9 ... 232	2,35	8216500.0000.00000
	G1 1/2	40	G1/4	31	0,2 ... 16	2,9 ... 232	2,1	8216600.0000.00000
	G2	50	G1/4	46	0,2 ... 16	2,9 ... 232	3,35	8216700.0000.00000

\*1) Cv-value (US) ≈ kv value x 1,2

\*2) For gases and liquid fluids up to 80 mm<sup>2</sup>/s (cSt)

Option selector

82★6★ ★★.0000.00000

Thread form	Substitute
ISO G	1
Port size	Substitute
1/4"	0
3/8"	1
1/2"	2
3/4"	3
1"	4
1 1/4"	5
1 1/2"	6
2"	7

Options (Valves)	Substitute
Fabric diaphragm FPM with valve plate Tmax. +110°C Operating pressure 0,2 ... 16 bar Control pressure = Operating pressure G1/4 ... 1/2: max. control pressure 6 bar over operating pressure but max. control pressure 16 bar G3/4 ... 2: max. control pressure 1 bar over operating pressure but max. control pressure 16 bar	03
Fabric diaphragm NBR with valve plate Tmax. +90°C Operating pressure 0,2 ... 16 bar Control pressure = Operating pressure G3/4 ... 2: max. control pressure 6 bar over operating pressure but max. control pressure 16 bar	51
Fabric diaphragm FPM with valve plate Tmax. +110°C Operating pressure 0,2 ... 16 bar Control pressure = Operating pressure G3/4 ... 2: max. control pressure 6 bar over operating pressure but max. control pressure 16 bar	52
Suitable for vacuum with pressure spring under diaphragm, FPM-fabric diaphragm Tmax. +110°C Operating pressure -0,9 ... 16 bar Control pressure 2 ... 16 bar max. control pressure 6 bar over operating pressure	53
Suitable for vacuum with pressure spring under diaphragm, FPM-fabric diaphragm Tmax. +90°C Operating pressure -0,9 ... 16 bar Control pressure 2 ... 16 bar max. control pressure 6 bar over operating pressure	54

Further options on request!

Section View

G1/4 ... 2

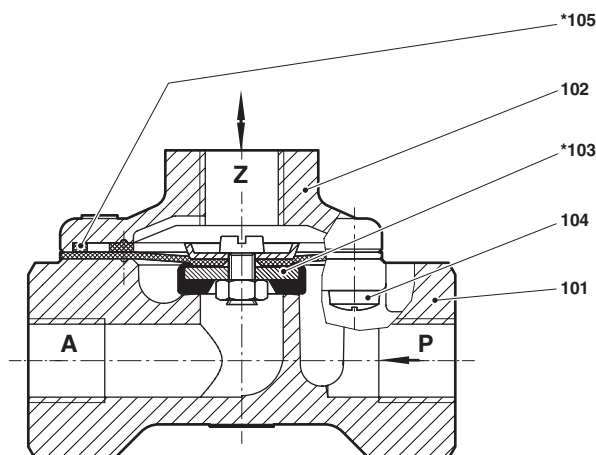

No.	Description
101	Valve body
102	Valve cover
*103	Diaphragm
104	Oval head cap screw up to G1/2 Allen head screw from G3/4
*105	Gasket, not for G3/4 and G1

\* These individual parts form a complete wearing unit.  
When ordering spare parts please state Model No. and Series No.

**Dimensions**
**G1/4 ... 2**

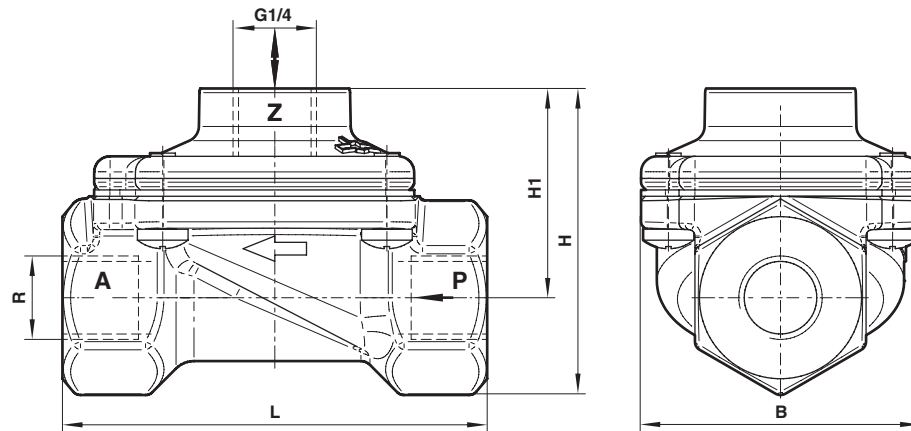
 Dimensions in mm  
 Projection/First angle

Port size R	B *3)	H	H1	L	Model
G1/4	44	48	33	67	8216000.0000.00000
G3/8	44	48	33	67	8216100.0000.00000
G1/2	44	48	33	67	8216200.0000.00000
G3/4	70	81	57	95	8216300.0000.00000
G1	70	81	57	95	8216400.0000.00000
G 1 1/4	96	103	70	132	8216500.0000.00000
G1 1/2	96	103	70	132	8216600.0000.00000
G2	112	121	81	160	8216700.0000.00000

\*3) max. depth

**Note to Pressure Equipment Directive (PED):**

The valves of this series up to and including DN 25 (G1) are according to Art. 4 § 3 of the Pressure Equipment Directive (PED) 2014/68/EU. This means interpretation and production are in accordance to engineers practice wellknown in the member countries. A certificate of conformity is not designated.

**For valves > DN 25 (G1) Art. 4 § (1) Letter d) applies:**

The basic requirements of the Enclosure I of the PED must be fulfilled. The CE-sign at the valve refers to the PED. A certificate of conformity of this directive will be available on request.

**Note to EAC marking:**

The EAC-marked products comply with the applicable requirements stated in the technical regulations of the Eurasian Economic Union.