

## DH series Double shut off quick release couplings

- Normal size:  
Ø 4,3 ... 25 mm
- Single handed operation
- Heavy duty
- Good flow rates
- Industrial standard



### Technical features

**Medium:**  
Liquid fluids

**Operation:**  
Double shut off:  
After disconnection the flow stops in both coupling and plug.  
The medium is retained in both connection lines and pressure is not released

**Operating pressure:**  
See table below

**Ambient/Media temperature:**  
Brass version  
-20°C ... +100°C (-4 ... +212 °F)  
Stainless steel version  
-15 ... +200°C (-5 ... +392 °F)  
Air supply must be dry enough to avoid ice formation at temperatures below +2°C (+35 °F).

**Materials:**  
Brass version:  
Body, valve, sleeve: brass (Ms 58)  
Spring and locking ring: stainless steel (1.4310)  
Locking balls: stainless steel (1.4034)  
Seals: NBR

Stainless steel version:  
Body, valve, sleeve: stainless steel  
Spring and locking ring: stainless steel (1.4310)  
Locking balls: stainless steel (1.4034)  
Seals: FPM

### Technical data

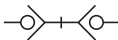
| Symbol  | Nominal size | Port size | Operating pressure (bar) | Body material   | Model Coupling | Plug        |
|---|--------------|-----------|--------------------------|-----------------|----------------|-------------|
|  | 4,3          | G 1/8     | 250                      | Brass           | DHS-220BP      | DHP-220BP   |
|   | 6,3          | G 1/4     | 250                      | Brass           | DHS-440BP      | DHP-440BP   |
|   | 10           | G 3/8     | 200                      | Brass           | DHS-660BP      | DHP-660BP   |
|   | 12,5         | G 1/2     | 150                      | Brass           | DHS-880BP      | DHP-880BP   |
|   | 20           | G 3/4     | 100                      | Brass           | DHS-12120BP    | DHP-12120BP |
|   | 25           | G 1       | 100                      | Brass           | DHS-16160BP    | DHP-16160BP |
|   | 6,3          | G 1/4     | 250                      | Stainless steel | DHS-440VP      | DHP-440VP   |
|   | 10           | G 3/8     | 250                      | Stainless steel | DHS-660VP      | DHP-660VP   |
|   | 12,5         | G 1/2     | 250                      | Stainless steel | DHS-880VP      | DHP-880VP   |
|   | 20           | G 3/4     | 160                      | Stainless steel | DHS-12120VP    | DHP-12120VP |
|   | 25           | G 1       | 100                      | Stainless steel | DHS-16160VP    | DHP-16160VP |

### Option selector

| Shape     | Substitute | Material        | Substitute |
|-----------|------------|-----------------|------------|
| Plug      | P          | Brass           | B          |
| Coupling  | S          | Stainless steel | V          |
| Port size | Substitute |                 |            |
| G1/8      | 220        |                 |            |
| G1/4      | 440        |                 |            |
| G3/8      | 660        |                 |            |
| G1/2      | 880        |                 |            |
| G3/04     | 12120      |                 |            |
| G1        | 16160      |                 |            |

DH★-★★★★★P

## Couplings and plugs

Coupling - brass version  
DHS-..... BP



Page 2

Coupling - stainless steel version  
DHS-..... VP



Page 2

Plug - brass version  
DHP-..... BP



Page 2

Plug - stainless steel version  
DHP-..... VP



Page 2

## Water flow

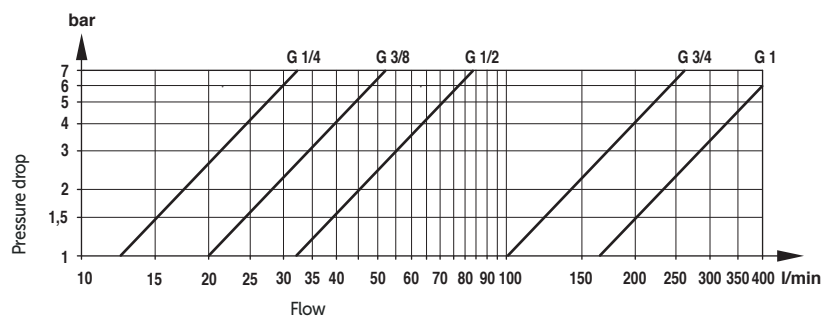

Dimensions in mm  
Projection/First angle



## Coupling – female thread

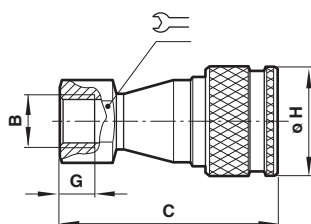

## Plug – female thread

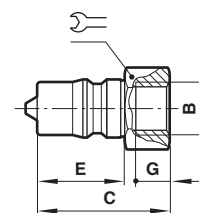

| Nominal size | B     | C    | G    | øH   |    | Model       |
|--------------|-------|------|------|------|----|-------------|
| 4,3          | G1/8  | 48,5 | 7    | 25,5 | 14 | DHS-220BP   |
| 6,3          | G 1/4 | 57,5 | 10   | 28,5 | 19 | DHS-440*P   |
| 10           | G 3/8 | 64   | 11,5 | 35   | 22 | DHS-660*P   |
| 12,5         | G 1/2 | 74   | 15,5 | 44,5 | 27 | DHS-880*P   |
| 20           | G 3/4 | 96   | 22   | 55   | 27 | DHS-12120*P |
| 25           | G 1   | 106  | 20   | 62   | 41 | DHS-16160*P |

\* B = brass, V = stainless steel

| Nominal size | B     | C    | E    | G    |    | Model       |
|--------------|-------|------|------|------|----|-------------|
| 4,3          | G1/8  | 29   | 20   | 8    | 14 | DHP-220BP   |
| 6,3          | G 1/4 | 35,5 | 23,5 | 10   | 19 | DHP-440*P   |
| 10           | G 3/8 | 39   | 27   | 11,5 | 22 | DHP-660*P   |
| 12,5         | G 1/2 | 46   | 30   | 15,5 | 27 | DHP-880*P   |
| 20           | G 3/4 | 60   | 40   | 22   | 36 | DHP-12120*P |
| 25           | G 1   | 65   | 44   | 20   | 41 | DHP-16160*P |

\* B = brass, V = stainless steel

## Warning

These products are intended for use in industrial compressed air and fluid systems only. Do not use these products where pressures and temperatures can exceed those listed under **»Technical features/data«**. Before using these products with fluids other than those specified, for non-industrial applications, life-support systems, or other applications not within published specifications, consult IMI NORGRN.

Through misuse, age, or malfunction, components used in fluid power systems can fail in various modes. The system designer is warned to consider the failure modes of all

component parts used in fluid power systems and to provide adequate safeguards to prevent personal injury or damage to equipment in the event of such failure.

System designers must provide a warning to end users in the system instructional manual if protection against a failure mode cannot be adequately provided.

System designers and end users are cautioned to review specific warnings found in instruction sheets packed and shipped with these products.