

## Inline Pressure Protection Valve 5200-75

### Features

Norgren GT Development Inline Pressure Protection Valve with DOT push-to-connect fittings designed to isolate vehicle air systems in case of leakage, protects the integrity of the air supply.



### Performance

<b>Application</b>	Designed to isolate vehicle air systems in case of leakage. Protects the integrity of the air supply.
<b>Material</b>	Thermoplastic Body with Fluorosilicone Seals.
<b>Part Number</b>	5200-75
<b>Rated PSI</b>	150 PSIG maximum
<b>Operating Temperature</b>	-40°F to 230°F
<b>Equivalent Orifice</b>	Cd = .65 equivalent orifice = .07" minimum. The valve shall flow 10 SCFM minimum with 120 PSIG applied at the inlet and the outlet at ambient air pressure.
<b>Flow Rate</b>	3.3 SCFM minimum with 120 PSIG at the inlet and 110 PSIG at the outlet.
<b>Connectors</b>	1/4" push-to-connect fittings meeting FMVSS 571.106 standards when used with SAE J844 tubing.
<b>Opening Pressure (On Rising Pressure)</b>	75 PSIG ± 10 PSIG
<b>Closing Pressure (On Closing Pressure)</b>	60 PSIG ± 5 PSIG
<b>Supply Port</b>	1/4"
<b>Delivery Port</b>	1/4"
<b>Spray Cap</b>	Black

## Pressure Protection Valve Cross Reference

Part Number 223-XXX	Cap Color	Open (PSIG)	Close (PSIG)	Outlets (Female)	Inlet (Male)	<sup>2</sup>	Close <sup>4</sup>	Open <sup>4</sup>
355, 355V	Black	55 ± 10	45 ± 10	3/8 - 18 NPT	3/8 - 18 NPT	0.62	2.48 ± .05	2.68 MAX
365	Black	65 ± 10	55 ± 5					
375	Black	75 ± 10	60 ± 5					
385, 385V	Red	85 ± 10	67 ± 5					
455, 455V	Black	55 ± 10	45 ± 10					
465, 465V	Black	65 ± 10	55 ± 5					
475	Black	75 ± 10	60 ± 5					
485	Red	85 ± 10	67 ± 5					
485V, 485V2	Red	85 ± 10	67 ± 5					
565, 565-1	Black	65 ± 10	55 ± 5					
565-2	Black	65 ± 10	55 ± 5					
585-V	Red	85 ± 10	67 ± 5					
585-1 <sup>1</sup>	Red	≤ 100	≥ 70					
585-1 <sup>1</sup>	Red	≤ 100	≥ 70					
585-2 <sup>3</sup>	Red	≤ 100	≥ 70					
585-2B, 285-2BV <sup>5</sup>	Black	85 ± 10	67 ± 5					
585N, 585NP <sup>1 6</sup>	Red	85 ± 10	67 ± 5					
585T <sup>5</sup>	Red	85 ± 10	67 ± 5					
685V	Red	85 ± 10	67 ± 5	1/4 - 18 NPT	3/8 - 18 NPT	0.62	2.48 ± .05	2.68 MAX
785	Red	≤ 100	≥ 70	3/8-1/8 NPT	1/2-14 PTF SAE SHORT	0.69	2.56 ± .05	2.76 MAX

<sup>1</sup> One of the outlet ports to be plugged (223-585, 585-1, and 585NP only) pipe sealant PST 567 applied to male thread plug

<sup>2</sup> Thread height

<sup>3</sup> No plug for 223-585-2

<sup>4</sup> Open and closed piston travel height

<sup>5</sup> Vibra-Seal applied to male threads for 223-585N, 585NP, and 585-2BV

<sup>6</sup> Internal 1/4-18 NPT thread only, no nipple

## Dimensions (Inches)

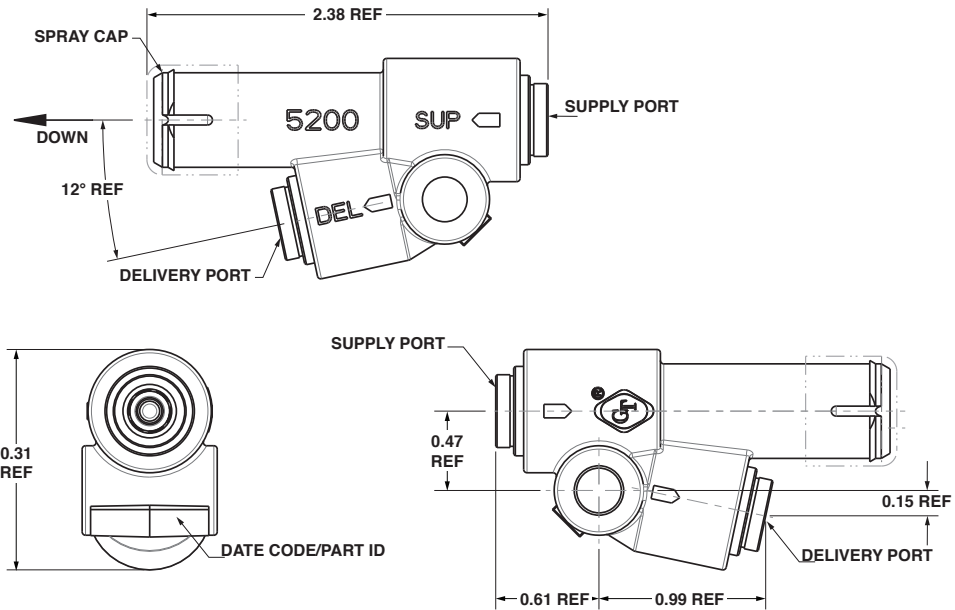

## Warning

Improper selection, misuse, age or malfunction of components used in commercial vehicle systems can cause failure in various modes. The system designer is warned to consider the failure modes of all component parts used in commercial vehicle systems and to provide adequate safeguards to prevent personal injury or damage to equipment or property in the event of such failure modes. System designers and end users are cautioned to consult instruction sheets and specifications available from the factory. The system designer/end user is responsible for verifying that all requirements for the application are met.

## Warranty

The products described herein are warranted subject to seller's Standard Terms and Condition of Sale, available at seller's website.