



NC - 113
September, 1969

TYPE FO1

COMPACT AIR LINE FILTER

1/4" - 3/8"

MANUAL OR AUTOMATIC DRAIN

WHERE TO USE

The FO1 Filter is designed for general application in compressed air systems where effective filtration is required.

SPECIFICATIONS

PIPE SIZES: 1/4", 3/8"
FILTER ELEMENTS: 50 MICRON (STANDARD)
5 AND 25 MICRON (OPTIONAL)
1/3 PINT SAFETY-GREEN BOWL
MAXIMUM RECOMMENDED OPERATING CONDITIONS:
SAFETY-GREEN BOWLS
250 PSIG AT 120° F. AMBIENT
200 PSIG AT 160° F. AMBIENT
100 PSIG AT 175° F. AMBIENT
AUTOMATIC OR MANUAL DRAIN
MOUNTING HOLES: STANDARD 13/64"

FEATURES

- A Excellent water removal characteristics.
- B Interchangeable automatic drain or manual drain.
- C Threaded bowl is easily removed by hand.
- D Safety-Green, transparent, non-shattering bowl.
- E Acetal resin insert with drain cock reduces bowl stress.
- F Built-in mounting provision.
- G Sintered bronze element.

HOW TO ORDER

If filter is not listed in the Order Table, you can order by specifying:

NPT Connections (1/4", 3/8") _____
Micron ratings (5, 25, 50) _____
Bowl Drain (manual, automatic) _____
Type of Bowl (metal, transparent, bowl guard) _____

CAUTION

THIS FILTER SHOULD NOT BE USED IN APPLICATIONS WHICH MAY EXCEED MAXIMUM RECOMMENDED OPERATING CONDITIONS. DURING MAINTENANCE PERIODS CLEAN AND INSPECT EACH PART CAREFULLY USING ONLY CLEAR, WARM WATER OR KEROSENE. DO NOT USE SOLVENTS AS THE POLYCARBONATE BOWL MAY BE DAMAGED.

NORGREN
LITTLETON, COLORADO

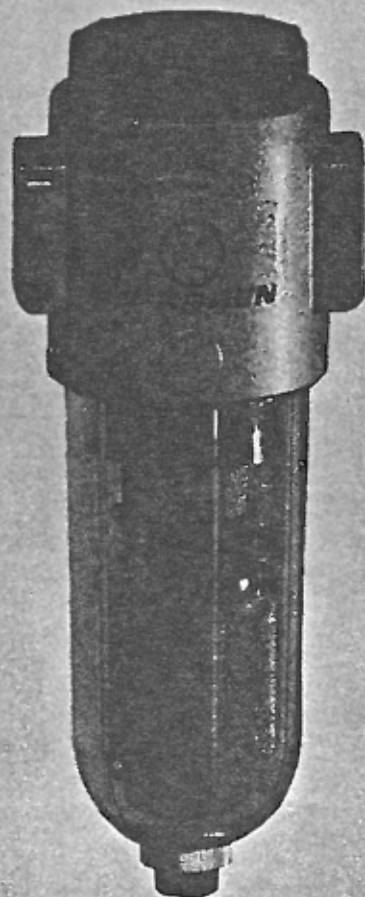
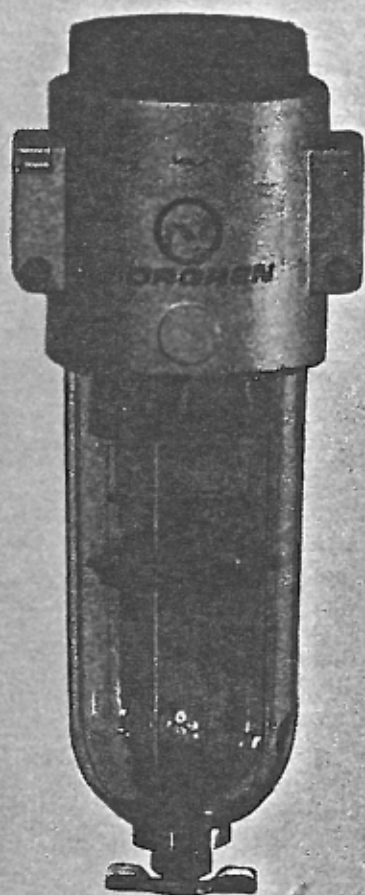

PARTS

REPAIR KITS (Contains All Elastomers)	(25 & 50 micron)	3163-01
	(5 micron)	3163-02
REPLACEMENT PARTS		
Filter Elements - 5 micron		3163-03
25 micron		3161-02
50 micron		3161-03
Transparent bowl assembly (manual drain)		3155-53
Float (for automatic drain models)		3003-50
Automatic drain assembly (for automatic drain models)		3000-03
Transparent bowl (for automatic drain models, includes automatic drain assembly)		3154-55

FOR ORDERING INFORMATION REFER TO NC-113

MAINTENANCE

The filter must be disassembled for cleaning and servicing. To do this, first shut off the air supply and bleed down pressure; then remove the threaded bowl (12) by unscrewing (counter-clockwise). The gasket (9) will normally remain with the bowl.

Remove the baffle (8) by unscrewing it (counter-clockwise) from the filter guide (5). The filter element (6) and filter shield (7) will drop off with the baffle. The louver-deflector assembly (4) can be removed by first unscrewing (counter-clockwise) the filter guide (5). A 1/2" open-end wrench is required to remove the filter guide (5).

Should it be necessary to remove the manual-drain assembly, unscrew drain cock (14) from the insert (10); then unscrew the retaining ring (13) from the insert, and remove the insert (10) itself. Cap (1) is not removable. 5 micron filter elements require gaskets (19) at top and (20) at bottom to prevent leakage around element.

CAUTION: CLEAN AND INSPECT EACH PART CAREFULLY USING ONLY CLEAR, WARM WATER OR KEROSENE. BLOW AIR THROUGH ELEMENT INSIDE, TO OUTSIDE TO DISLodge SURFACE CONTAMINENTS.

Repair Kits or Replacement Parts should be ordered from the Norgren Distributor in your area, using the Table above.

On filters containing an automatic drain, the strainer (15) and float assembly (16) are not attached and will drop out when bowl is turned upside down. The float (16) and automatic drain (17) assemblies are not considered to be repairable items. The automatic drain is easily removed by loosening the retaining ring (13). Care should be taken when reassembling to install gasket (11) on bottom of automatic drain before placing in bowl. A recess is provided in Baffle (8) for correct positioning of the strainer

CAUTION

THIS FILTER SHOULD NOT BE USED IN APPLICATIONS WHICH MAY EXCEED MAXIMUM, RECOMMENDED OPERATING CONDITIONS. DURING MAINTENANCE PERIODS CLEAN AND INSPECT EACH PART CAREFULLY USING ONLY CLEAR, WARM WATER OR KEROSENE. DO NOT USE SOLVENTS AS THE POLYCARBONATE BOWL MAY BE DAMAGED.

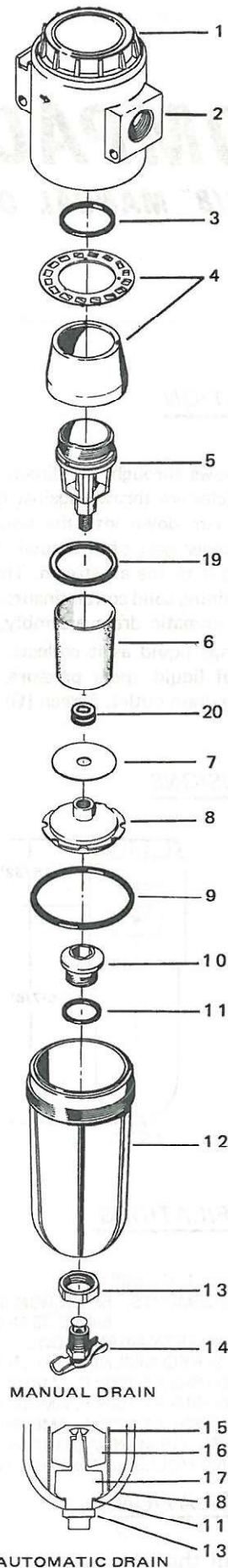

C. A. NORNGREN CO.
 LITTLETON, COLORADO 80120 303.794-2611