

Operation Manual

Using Excelon® Plus and Excelon Clamps



Before starting work read these instructions.

This manual contains proprietary information. No part of this publication may be reproduced, transcribed or transmitted in any form without the written consent of the publisher. Every effort has been made to ensure that the information contained in this manual is accurate. All rights reserved.

Contents

Using the Hybrid Clamp (84 to 74)	3
Using the Hybrid Clamp (84 to 84)	3
Excelon clamp 74 to 74	4
Excelon clamp 74 to 84	4
Excelon® Plus clamp 84 to 84	5
Excelon® Plus clamp 84 to 74	5
Excelon® Plus 82 Series & Excelon 72 Series	5

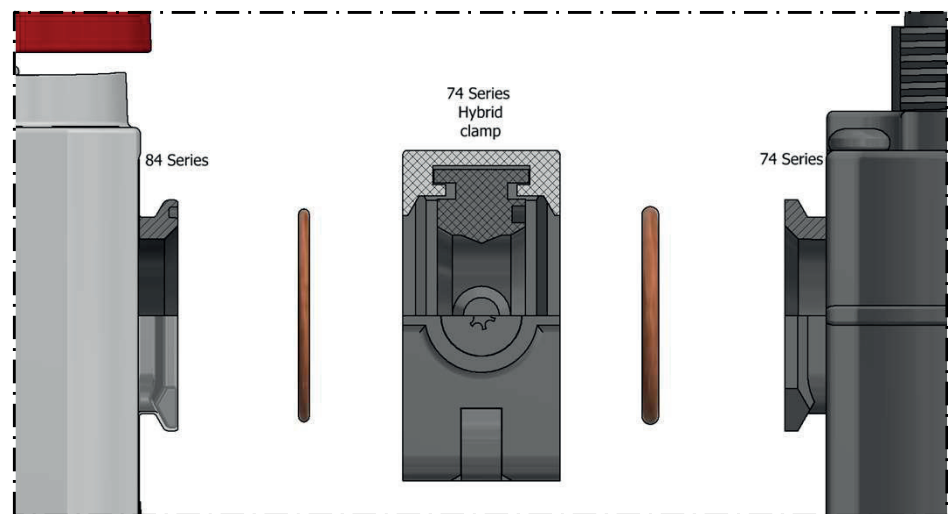
**Using the Hybrid Clamp
(84 to 74)**

Both the hybrid clamp 840014-61 or hybrid clamp with bracket 840014-62 were designed to allow connection of the Excelon® Plus to Excelon series.

In the example above, with flow left to right, the hybrid clamp accommodates connecting an Excelon Plus 84 series product to an Excelon 73/74 series product using a clamp with an Excelon footprint (24.5mm wide)

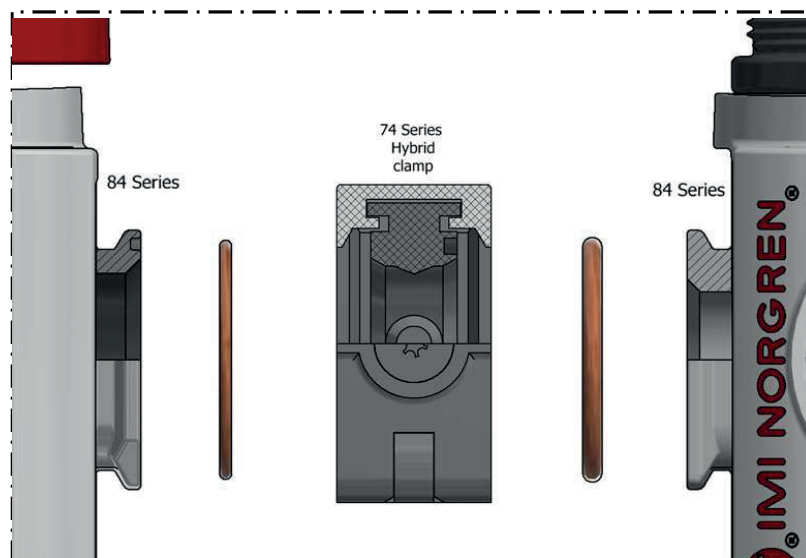
**Using the Hybrid Clamp
(84 to 84)**

Both the hybrid clamp 840014-61 or hybrid clamp with bracket 840014-62 were designed to allow connection of the Excelon® Plus to Excelon series. But the clamp can also be used to accommodate connecting two Excelon® Plus 84 series products together (clamp footprint is 24.5mm wide)

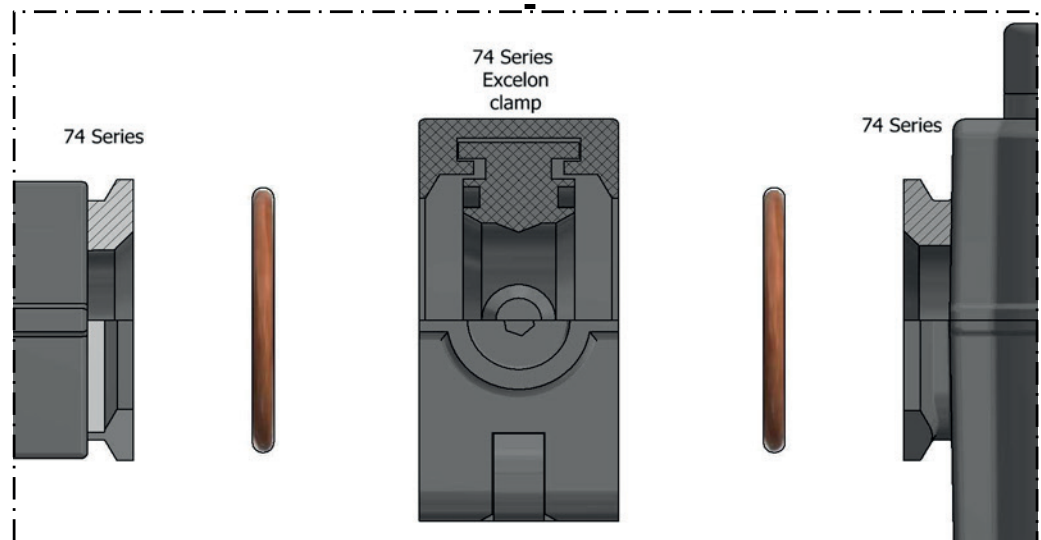
Excelon clamp 74 to 74

Shown above is the Excelon clamp 4314-51 (clamp with bracket 4314-52) connecting two Excelon 73/74 series products together (clamp footprint is 24.5mm wide)

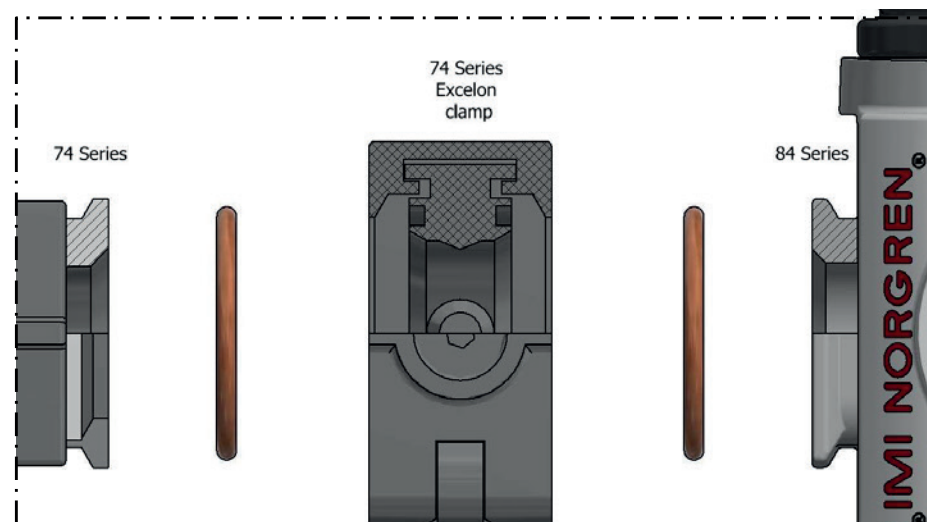
Excelon clamp 74 to 84

In the example above, with flow left to right, a 73/74 series Excelon product and an Excelon clamp 4314-51 (clamp with bracket 4314-52) connecting to an Excelon® Plus 84 series

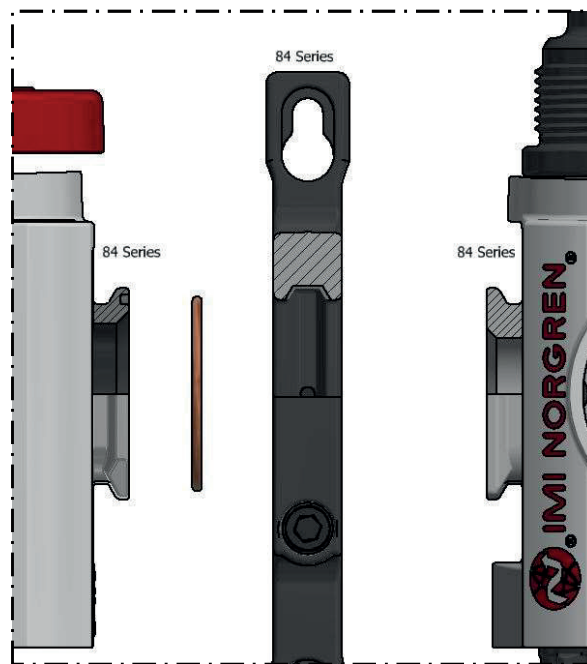
Excelon® Plus clamp 84 to 84

Excelon® Plus 84 series has a zero space connection system, meaning that the connecting face of each product is mated in a clamp (840014-51KIT) which contains no spacer, subsequently the design incorporates a flat surface on the inlet and a recess for an O ring on the outlet face. (clamp with bracket P/N 840014-52KIT)

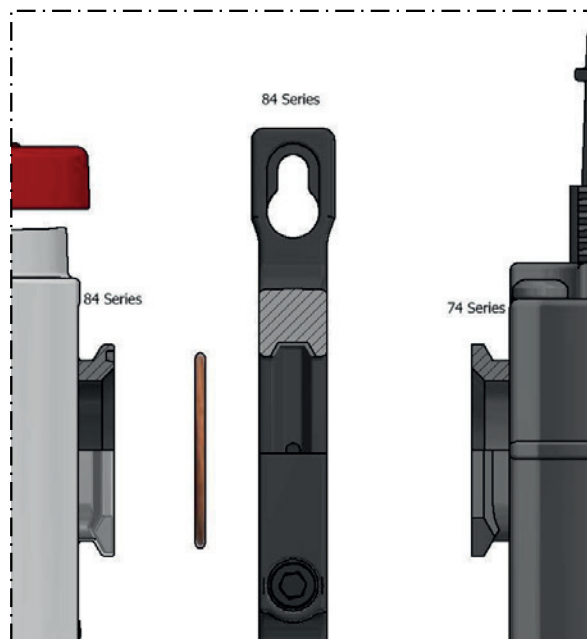
Excelon® Plus clamp 84 to 74

The inlet face of a 73/74 Excelon product has the same flat interface as the inlet face of a 84 series Excelon® Plus therefore an 84 series clamp, 840014-51KIT or clamp with bracket 840014-52KIT can be used as the connection system.

**Excelon® Plus 82 Series &
Excelon 72 Series**

Both the old and the new range in this smaller series have a spacer within the clamp design and therefore you can mix and match both series and clamps as either will work.

Norgren operates four global centres of technical excellence and a sales and service network in 50 countries, as well as manufacturing capability in Brazil, China, Czech Republic, Germany, India, Mexico UK and the USA.

For information on all Norgren companies visit

www.norgren.com

Supported by distributors worldwide.

For further information, scan this QR code or visit
www.norgren.com



Norgren, Buschjost, FAS, Herion, Kloehn, Maxseal and Thompson Valves are registered trademarks of Norgren companies.

Due to our policy of continuous development, Norgren reserve the right to change specifications without prior notice.

OM_AL_Excelon Plus_Full Porting
Block en/01/22

Selected Images used under
license from Shutterstock.com

Incorporating



IMI