

- > Port size:
DN 4,5; G1/4
- > Functional design
- > Sealed core tube chamber
- > Wetted Polymer parts with drinking water approval acc. KTW-reference and DVGW-process-sheet W 270
- > Back pressure tight up to 10 bar
- > Voltage range
16 ... 32 V
- > Core tube protected with PTFE-bellow
- > Unsusceptible to calcification and magnetization of foreign particles
- > Shock and vibration tested to EN 61373, Category 1, class B

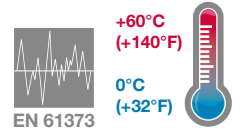

Technical features

Medium:

Water

Switching function:

Normally closed

Operation:

Directly solenoid actuated

Type:

Seat valve operating without differential pressure

Mounting position:

Optional, preferably solenoid vertical on top

Flow direction:

Determined

Port size:

G1/4, DN 4,5

Operating pressure:

0 ... 1,5 bar (0 ... 21,8 psi)

Fluid temperature:

0 ... +60°C (+32 ... +140°F)

Ambient temperature:

0 ... +50°C (+32 ... +122°F)

Material:

Body: Brass

Seat seal: EPDM

Internal parts: PTFE-bellows

For contaminated fluids (particle > 1 mm) insertion of a strainer is recommended.

Technical data

Symbol	Port size	Orifice (mm)	Flow kv value *1) (m ³ /h)	Operating pressure *2) (bar)	Weight (kg)	Model Solenoid in V d.c.
	G1/4	4,5	0,42	0 ... 1,5	0,4	8499986.8264.02400

*1) Cv-value (US) ≈ kv value x 1,2

*2) For gases and liquid fluids up to 80 mm²/s (cSt)

Standard solenoid systems

Voltage and Frequency Solenoid 8264					
Code Voltage	Code Frequency	Voltage	Frequency	Power consumption	
				Inrush	Holding
024	00	24 V d.c.	-	10 W	10 W

Further versions on request!

Electrical details for all solenoid systems

Design	DIN VDE 0580
Voltage range	16 ... 32 V
Duty cycle	100% ED
Protection class	EN 60529 IP65/IP00
Socket	Form A acc. to DIN EN 175301-803 (included)

According to DIN VDE 0580 at a solenoid temperature of +20°C.
At operating state temperature the input power of a coil decreases by up to ca. 30% due to physical reasons.

Dimensions

Dimensions in mm
Projection/First angle

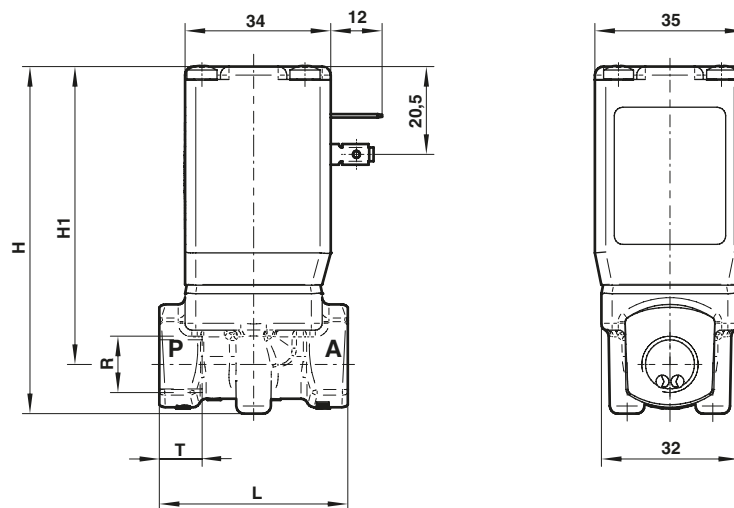

Port size R	Orifice (mm)	H	H1	L	T	Model
G1/4	4,5	81	70	44	10	8499986.8264.02400

Note to Pressure Equipment Directive (PED):

The valves of this series are according to Art. 4 § 3 of the Pressure Equipment Directive (PED) 2014/68/EU. This means interpretation and production are in accordance to engineers practice well-known in the member countries. The CE-sign at the valve does not refer to the PED. Thus the declaration of conformity is not longer applicable for this directive.

Note to Electromagnetic Compatibility Guideline (EMC):

The valves shall be provided with an electrical circuit which ensures the limits of the harmonised standards EN 61000-6-3 and EN 61000-6-1 are observed, and hence the requirements of the Electromagnetic Compatibility Guideline 2014/30/EU satisfied.