

- > Port size: Ø 4 ... 12 mm
- > High flow performance
- > In-line or panel mounting
- > Adjustment can be locked
- > Captive regulator needle will not blow out when unscrewed
- > Nickel plated brass components provide corrosion and contamination resistance and an extended life.
- > Immediate quality sealing using silicone free U-packing.



Technical features

Medium:

Compressed air

Operating pressure:

10 bar max.

Tube sizes:

4 ... 12 mm

Tubing types:

PA 11 or 12

PU 85, 95 or 98 durometer

Ambient/Media temperature:

0°C ... +60°C (+32 ... +140°F)

Air supply must be dry enough to avoid ice formation at temperatures below +2°C (+35°F).

Materials:

Body: PBT

Seals: NBR (VMQ free)

u-packing and O-rings

Release sleeve and backing ring:

POM

Grab-ring: stainless steel

Collar: ZNDC

Technical data, standard models

Symbol	Tube size	Mounting	Weight (g)	Model
	4	In-line	13	C00GE0400
	6	In-line	28	C00GE0600
	8	In-line	45	C00GE0800
	10	In-line	84	C00GE1000
	12	In-line	123	C00GE1200
	4	In-line and panel	18	C00GP0400
	6	In-line and panel	37	C00GP0600
	8	In-line and panel	67	C00GP0800
	10	In-line and panel	110	C00GP1000
	12	In-line and panel	151	C00GP1200

Options selector

C00G★★★00

Mounting	Substitute
In-line	E
In-line and panel	P

O/D tube	Substitute
4	04
6	06
8	08
10	10
12	12

Method of assembly

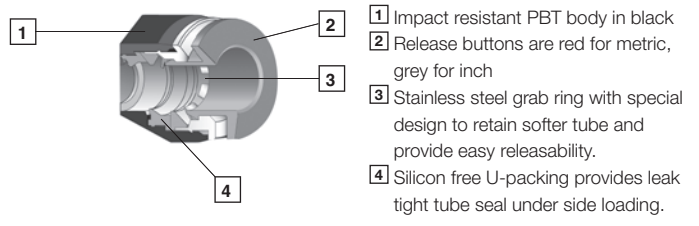
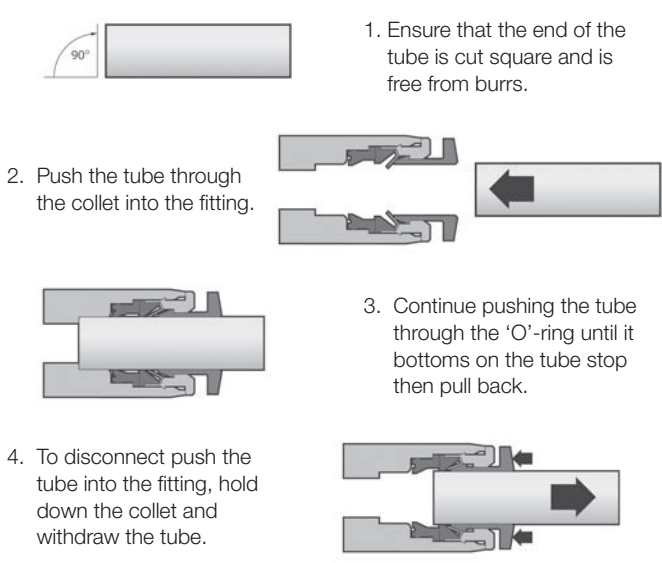

Technical data

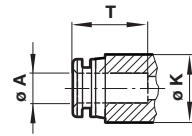

Ø A	Ø K	T*1)
4	10,5	15
6	12,5	16,5
8	14,5	18,5
10	17,5	20
12	20,5	23
16	27	23,5

*1) Dimensions here and in the individual tables refer to the collet being in the 'IN' position.

Speed controllers flowrate

Ø 4 mm

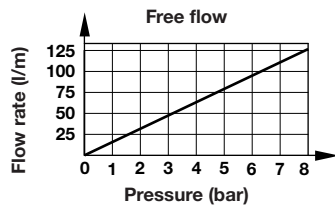
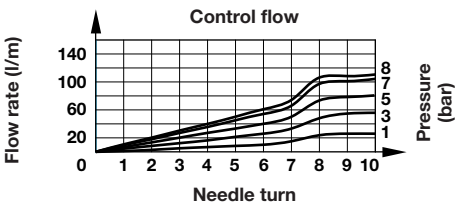

Ø 6 mm

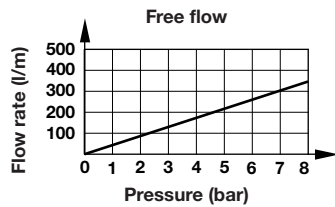
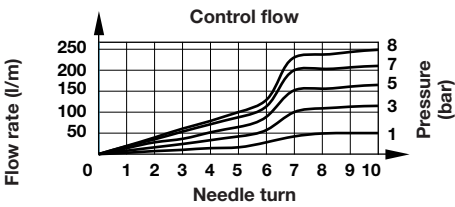

Ø 8 mm

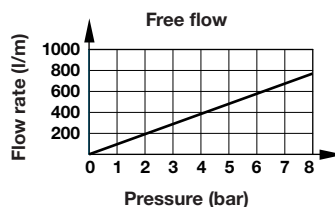
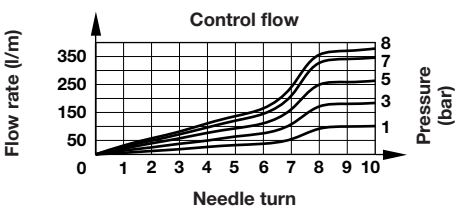

Ø 10 mm

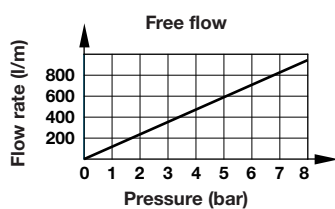
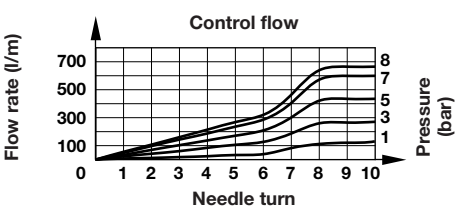

Speed controllers flowrate

Ø 12 mm

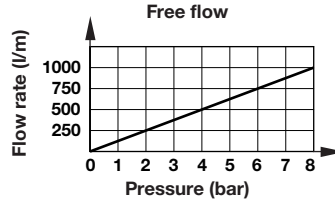
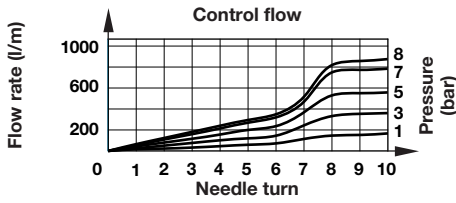

In-line flow control
C00GE

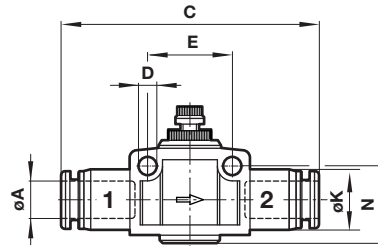
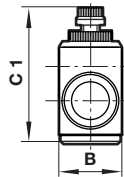
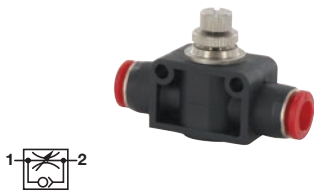

Dimensions in mm
Projection/First angle



Ø A	B	C	C1 min.	max.	D	E	Ø K	N	Model
4	12	45	30	33	3,3	15	11	13,5	C00GE0400
6	16	50	35	39,5	4,4	20,5	13	17,5	C00GE0600
8	19	55,5	37,5	42	4,4	23	15	20	C00GE0800
10	23	61	44	49	4,4	28	17,5	23	C00GE1000
12	26,5	70	47,5	53,5	4,4	32	20,5	25,5	C00GE1200

In-line and panel mounting flow control
C00GP

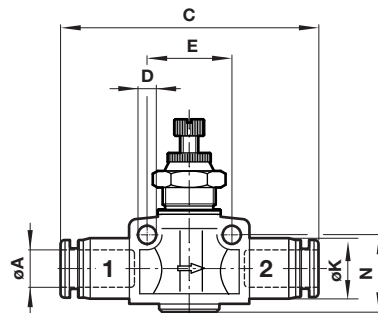
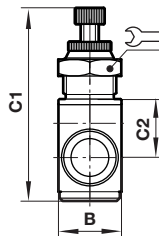
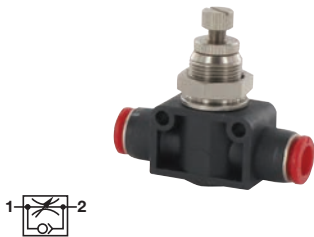

Ø A	B	C	C1 min	max.	C2	D	E	Ø K	N	Panel hole	Panel thickness	Model	
4	12	42	35,5	38	5,5	3,2	15,5	11	13,5	12	11	5	C00GP0400
6	16	49,5	43	48,5	8	4,3	20,5	13	17,5	17	15	6	C00GP0600
8	19	56,5	47,5	53	8,5	4,3	23	15	20	19	17	6	C00GP0800
10	23	63	53,5	61,5	10,5	4,3	27,5	17,5	23	22	17	7	C00GP1000
12	26,5	73,5	57,5	64,5	12	4,4	32,5	20,5	25,5	24	21	7	C00GP1200

Warning

These products are intended for use in industrial compressed air systems only. Do not use these products where pressures and temperatures can exceed those listed under »Technical features/data«.

Before using these products with fluids other than those specified, for non-industrial applications, life-support systems or other applications not within published specifications, consult IMI NORGREN.

Through misuse, age, or malfunction, components used in fluid power systems can fail in various modes.

The system designer is warned to consider the failure modes of all component parts used in fluid power systems and to provide adequate safeguards to prevent personal injury or damage to equipment in the event of such failure.

System designers must provide a warning to end users in the system instructional manual if protection against a failure mode cannot be adequately provided.

System designers and end users are cautioned to review specific warnings found in instruction sheets packed and shipped with these products.