

- > Port size: Ø 4 ... 12 mm
- > High flow performance
- > Nickel plated brass components provide corrosion and contamination resistance and an extended life.
- > Pre applied thread sealant on all taper threads and recessed captive O-ring on parallel threads provides optimum rapid sealing.



Technical features

Medium:
Compressed air
Operation:
self sealing
Operating pressure
10 bar max., (145 psi)
Vacuum up to 750 mm Hg

O/D tube size:
4 ... 12 mm
Thread size:
M5, 1/8, 1/4, 3/8 and 1/2
ISO G and ISO R

Tubing types:
PA 11 or 12
PU 85, 95 or 98 durometer
Ambient/Media temperature:
0°C ... +60°C (+32 ... +140°F)
Air supply must be dry enough to avoid ice formation at temperatures below +2°C (+35°F)

Materials:
Body: nickel plated brass
Seals: NBR
Release sleeve and backing ring: POM
Grab-ring: stainless steel
Collar: ZNDC
Thread sealant: (parallel):
Threebond 2350B

Option selector

C0★★★★★★

Thread form	Substitute
without	0
ISO R, taper	1
ISO G, parallel	2
Variants	Substitute
Straight adaptor	24
Swivel elbow	4J
Straight union	2J

Thread size	Substitute
M5	05
1/8"	18
1/4"	28
3/8"	38
1/2"	48
O/D tube size (mm)	Substitute
4	04
6	06
8	08
10	10
12	12

Method of assembly



1. Ensure that the end of the tube is cut square and is free from burrs.
2. Push the tube through the collet into the fitting.
3. Continue pushing the tube through the 'O'-ring until it bottoms on the tube stop then pull back.
4. To disconnect push the tube into the fitting, hold down the collet and withdraw the tube.

Components

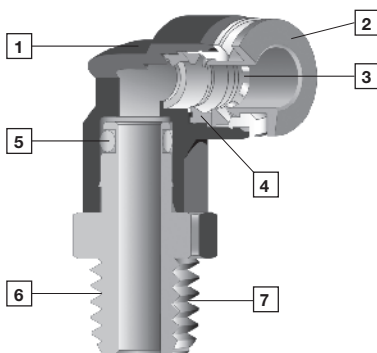

- 1 Impact resistant PBT body in black
- 2 Release buttons are red for metric, grey for inch
- 3 Stainless steel grab ring with special design to retain softer tube and provide easy releasability.
- 4 Silicon free U-packing provides leak tight tube seal under side loading.
- 5 Stem seal provides leak tight 360° swivel connection.
- 6 Nickel plated brass threads and notches on hex to signify NPT.
- 7 Pre-applied thread sealant on tapered threads and recessed captive O-ring on parallel threads.

Technical data

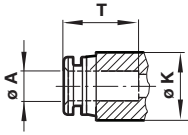

Ø A	Ø K	T*1)
4	10,5	15
6	12,5	16,5
8	14,5	18,5
10	17,5	20
12	20,5	23

*1) Dimensions here and in the individual tables refer to the collet being in the 'IN' position.

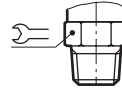

Thread	Recommended torque
M5	1,5 Nm
G1/8	10 Nm
R1/8	7 Nm
G1/4	15 Nm
R1/4	12 Nm
G3/8	25 Nm
R3/8	22 Nm
G1/2	40 Nm
R1/2	28 Nm

Self sealing fittings

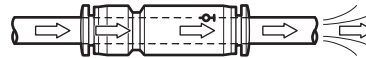
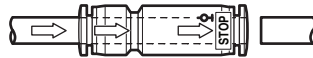

No air flow when tubing is removed - air flow is restored when tubing is inserted

Dimensions in mm
Projection/First angle



Straight adaptor
C0124

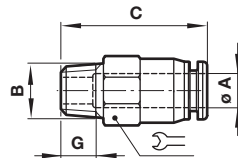

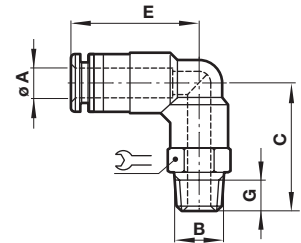

Swivel elbow
C014J



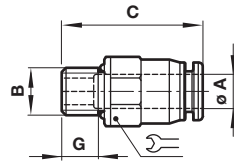

Ø A	B	C	G		Model
4	R1/8	26	8	10	C01240418
6	R1/8	29	8	12	C01240618
6	R1/4	29	10	14	C01240628
8	R1/4	33,5	10	14	C01240828
8	R3/8	33,5	11	17	C01240838
10	R1/4	35,5	10	17	C01241028
10	R3/8	35,5	11	17	C01241038
10	R1/2	35,5	14	21	C01241048
12	R1/4	42	10	19	C01241228
12	R3/8	42	11	19	C01241238
12	R1/2	42	14	21	C01241248

Ø A	B	C	E	G		Model
4	R1/8	27	27,5	5	10	C014J0418
6	R1/8	30	32	5	12	C014J0618
6	R1/4	32	30,5	6,5	14	C014J0628
8	R1/8	34,5	41,5	6,5	14	C014J0818
8	R1/4	34	40	6,5	17	C014J0828
10	R1/4	32	26,5	6,5	17	C014J1028
10	R3/8	36	45	6,5	17	C014J1038
10	R1/2	37,5	43	8	21	C014J1048
12	R3/8	40	53,5	6,5	19	C014J1238
12	R1/2	41,5	51,5	8	21	C014J1248

Straight adaptor
C0224

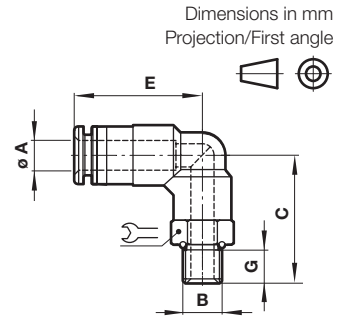
Ø A	B	C	G		Model
4	G1/8	25,5	5	12	C02240418
6	G1/8	28	5	12	C02240618
6	G1/4	27	6,5	15	C02240628
8	G1/4	32	6,5	15	C02240828
8	G3/8	32	6,5	17	C02240838
10	G1/4	35	6,5	17	C02241028
10	G3/8	36,5	6,5	17	C02241038
10	G1/2	37,5	8	21	C02241048
12	G1/4	43,5	6,5	19	C02241228
12	G3/8	43,5	6,5	21	C02241238
12	G1/2	44	8	21	C02241248

Swivel elbow
C024J

Ø A	B	C	E	G		Model
4	M5	20,5	29,5	4	10	C024J0405
4	G1/8	27	27,5	5	14	C024J0418
6	M5	22,5	33	4	12	C024J0605
6	G1/8	30	32	5	14	C024J0618
6	G1/4	32	30,5	6,5	14	C024J0628
8	G1/4	34,5	41,5	6,5	17	C024J0828
8	G3/8	34	40	6,5	20	C024J0838
10	G1/4	32	26,5	6,5	17	C024J1028
10	G3/8	36	45	6,5	20	C024J1038
10	G1/2	37,5	43	8	24	C024J1048
12	G3/8	40	53,5	6,5	20	C024J1238
12	G1/2	41,5	51,5	8	24	C024J1248

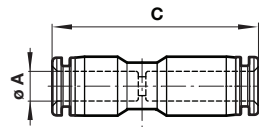
Straight union
C002J

Ø A	C	Model
4	42	C002J0400
6	46	C002J0600
8	53,5	C002J0800
10	58	C002J1000
12	67	C002J1200

Warning

These products are intended for use in industrial compressed air systems only. Do not use these products where pressures and temperatures can exceed those listed under

»Technical features/data«.

Before using these products with fluids other than those specified, for non-industrial applications, life-support systems or other applications not within published specifications, consult IMI NORGREN.

Through misuse, age, or malfunction, components used in fluid power systems can fail in various modes.

The system designer is warned to consider the failure modes of all component parts used in fluid power systems and to provide adequate safeguards to prevent personal injury or damage to equipment in the event of such failure.

System designers must provide a warning to end users in the system instructional manual if protection against a failure mode cannot be adequately provided.

System designers and end users are cautioned to review specific warnings found in instruction sheets packed and shipped with these products.