

L17 Micro-fog and oil-fog lubricators

- Port size: 3/4" ... 1 1/2" (ISO G/PTF)
- Micro-fog lubricators provide a fine mist for most general purpose pneumatic applications
- Oil-fog lubricators for heavy duty lubrication
- Can be serviced without the use of tools or removal from the air line



Technical features

<p>Medium: Compressed air only</p> <p>Maximum operating pressure: 17 bar (246 psi)</p> <p>Flow: See below</p> <p>Port size: 3/4", 1", 1 1/4" or 1 1/2"</p>	<p>Start point (minimum flow required for lubricator operation): 3,8 dm³/s (8 scfm) at 6,3 bar (90 psi) inlet pressure</p> <p>Bowl size: 0,5 or 1 litre</p>	<p>Fluid/Ambient temperature: -20 ... +80°C (0 ... +176°F) Air supply must be dry enough to avoid ice formation at temperatures below +2°C (+35°F).</p>	<p>Materials: Body and bowl: Aluminium alloy Sight feed dome: Transparent PA Elastomers: CR & NBR</p>
--	--	--	--

Technical data, standard models

Symbol	Port size	Flow *1) (dm ³ /s)	Lubricator type	Weight (kg)	Model
	G3/4	76	Micro-fog	1,69	L17-600-MP9G
	G1	130	Micro-fog	1,62	L17-800-MP9G
	G1 1/4	130	Micro-fog	2,11	L17-A00-MP9G
	G1 1/2	130	Micro-fog	1,67	L17-B00-MP9G
	G3/4	76	Oil-fog	1,69	L17-600-OP9G
	G1	130	Oil-fog	1,62	L17-800-OP9G
	G1 1/4	130	Oil-fog	2,11	L17-A00-OP9G
	G1 1/2	130	Oil-fog	1,67	L17-B00-OP9G

*1) Typical flow with 6,3 bar (90 psig) inlet pressure and 0,5 bar (7 psig) pressure drop

Option selector

		L17-★00-★P★★																												
<table border="1"> <thead> <tr> <th>Port size</th> <th>Substitute</th> </tr> </thead> <tbody> <tr><td>3/4"</td><td>6</td></tr> <tr><td>1"</td><td>8</td></tr> <tr><td>1 1/4"</td><td>A</td></tr> <tr><td>1 1/2"</td><td>B</td></tr> </tbody> </table>	Port size	Substitute	3/4"	6	1"	8	1 1/4"	A	1 1/2"	B	←	<table border="1"> <thead> <tr> <th>Thread</th> <th>Substitute</th> </tr> </thead> <tbody> <tr><td>PTF</td><td>A</td></tr> <tr><td>ISO G (standard)</td><td>G</td></tr> </tbody> </table>	Thread	Substitute	PTF	A	ISO G (standard)	G	→	<table border="1"> <thead> <tr> <th>Bowl</th> <th>Substitute</th> </tr> </thead> <tbody> <tr><td>0,5 litre, sight glass (standard)</td><td>9</td></tr> <tr><td>0,5 litre, manual drain, sight glass</td><td>7</td></tr> <tr><td>1 litre, manual drain, sight glass</td><td>D</td></tr> </tbody> </table>	Bowl	Substitute	0,5 litre, sight glass (standard)	9	0,5 litre, manual drain, sight glass	7	1 litre, manual drain, sight glass	D		
Port size	Substitute																													
3/4"	6																													
1"	8																													
1 1/4"	A																													
1 1/2"	B																													
Thread	Substitute																													
PTF	A																													
ISO G (standard)	G																													
Bowl	Substitute																													
0,5 litre, sight glass (standard)	9																													
0,5 litre, manual drain, sight glass	7																													
1 litre, manual drain, sight glass	D																													
<table border="1"> <thead> <tr> <th>Lubricator</th> <th>Substitute</th> </tr> </thead> <tbody> <tr><td>Micro-fog</td><td>M</td></tr> <tr><td>Oil-fog</td><td>O</td></tr> </tbody> </table>	Lubricator	Substitute	Micro-fog	M	Oil-fog	O	←																							
Lubricator	Substitute																													
Micro-fog	M																													
Oil-fog	O																													

Flow characteristics

Port size 1"

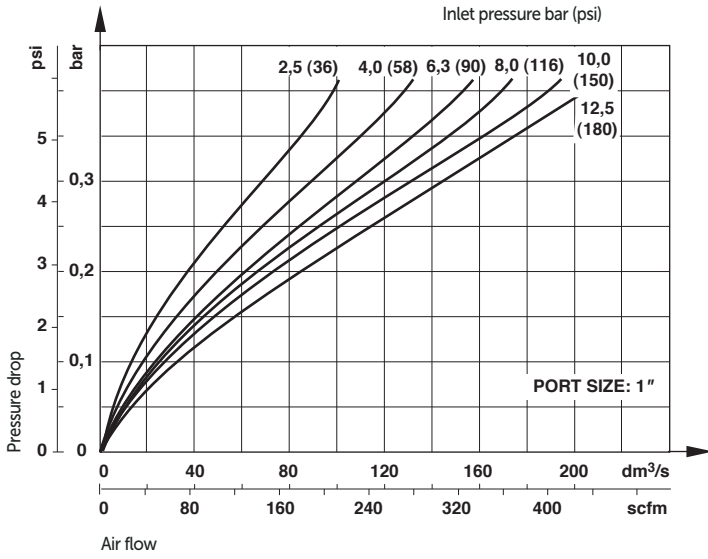

Accessories

Wall mounting bracket



Port size

3/4"	6212-50
1"	6212-50
1 1/4"	6212-51
1 1/2"	6212-51

Service kit

Service kit



5771-02

Dimensions

0,5 & 1 litre

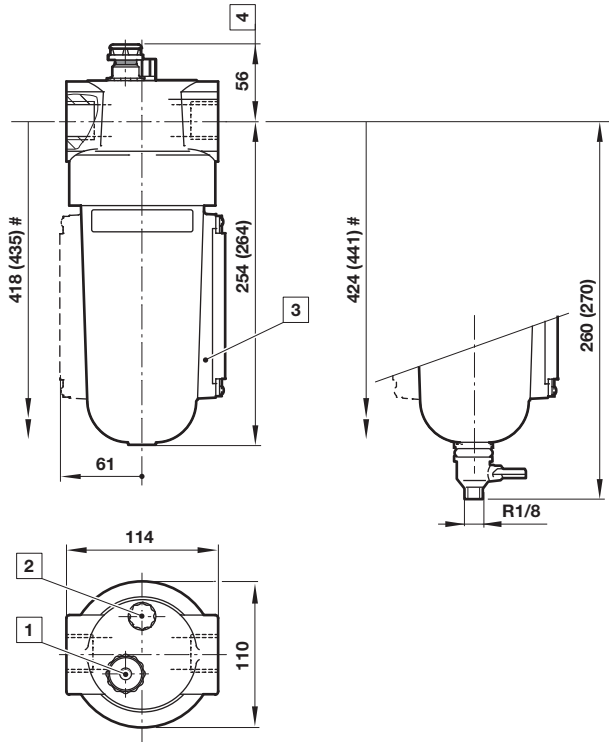

Min clearance required to remove bowl.

Values in () for 1" version

- 1 Oil adjustable screw
- 2 Oil fill plug
- 3 Sight-feed dome
- 4 Standard dome: 56 mm, Pyrex dome: 69 mm

Wall mounting brackets

6212-50, 6212-51

Dimensions in mm
Projection/First angle

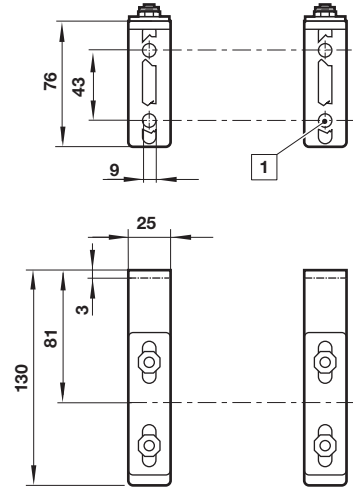

1 Mounting holes

Warning

These products are intended for use in industrial compressed air systems only. Do not use these products where pressures and temperatures can exceed those listed under »**Technical features/data**«.

Before using these products with fluids other than those specified, for non-industrial applications, life-support systems or other applications not within published specifications, consult IMI Precision Engineering, Norgren Inc.

Through misuse, age, or malfunction, components used in fluid power systems can fail in various modes. The system designer is warned to consider the failure modes of all component parts used in fluid power systems and to provide adequate safeguards to prevent personal injury or damage to equipment in the event of such failure.

System designers must provide a warning to end users in the system instructional manual if protection against a failure mode cannot be adequately provided.

System designers and end users are cautioned to review specific warnings found in instruction sheets packed and shipped with these products.