

# KIP Proportional Flow Control Valve

- 2/2 direct acting
- Designed for long life and reliability
- Ideally suited for a broad range of sectors
- Different materials available for compatibility with neutral gases and liquids
- Custom fitting or electrical hardware installation available upon request



## Specifications

<b>Operating Pressure:</b> 2/2: 0 to 125 psig	<b>Actuation:</b> Solenoid	<b>Electrical Connection:</b> Molded 24" leads standard (Class H) or dry taped 24" leads (Class H)	<b>Wattage:</b> 13 Watts, nominal
<b>Orifice</b> 1/32 3/64 1/16 5/64 standard	<b>Coil:</b> DC	<b>Switching Function:</b> 2/2: NC Singular outlet	<b>Duty Cycle:</b> Continuous
<b>Cv Range:</b> 0 to 200 SLPM	<b>Coil Class Options:</b> H: 356°F (180°C)	<b>Voltage Options:</b> 24VDC	<b>Weight:</b> 7oz, typical
	<b>Connection:</b> 1/8", 1/4" NPTF or manifold mount		<b>Material:</b> Body: brass or stainless steel Internal wetted parts: 430FR & 300 series CRES

## Options Selector

★PV★ ★★8★ - ★★ ★★ - ★★

<b>Prefix (optional)</b>	<b>Substitute</b>	←	<b>Voltage</b>	<b>Substitute</b>
O2 Service	Y		12 VDC <sup>*1)</sup>	12VDC
<b>Port Configuration</b>	<b>Substitute</b>	←	24 VDC	24VDC
1/8" NPTF	4		<b>Coil Options</b>	<b>Substitute</b>
1/4" NPTF	5		Dry taped with 24" Flying Leads, 13 Watt, Class H <sup>*1)</sup>	03
Manifold Mount	6		Free standing molded 24" Flying Leads, 13 Watt, Class H	63
<b>Housing</b>	<b>Substitute</b>	←	<b>Seal Options</b>	<b>Substitute</b>
Grommet	1		Buna (NBR)	01
Yoke	3		Fluorocarbon (FKM)	02
Slotted	9	←	Low Temp NBR	05
<b>Body Material</b>	<b>Substitute</b>	←	Low Temp FKM	07
Stainless Steel	0		Ethylene Propylene (EPR)	13
Brass	1	←		
<b>Function</b>	<b>Substitute</b>	←		
2WNC Proportional	8	←		
<b>Orifice</b>	<b>Substitute</b>			
1/32" <sup>*1)</sup>	0			
3/64" <sup>*1)</sup>	1			
1/16" <sup>*1)</sup>	2			
5/64"	3			

### Sample Part Number: PV63183-0263-24VDC

Series PV, 2-way normally closed proportional, manifold mount, brass, 5/64" orifice, FKM, yoke, molded coil w/24" leads, class 'H' (180°C), 24VDC @ 13-watt

\*1) These options are available with a 25 piece minimum order quantity

#### NOTES:

- Solenoid valves provide variable flow control proportional up to 100% duty cycle with a pulse width modulated 24VDC (500-Hz) control signal.
- Solenoid valves can be mounted in any position without affecting operation.

## Performance Characteristics

### Typical Response

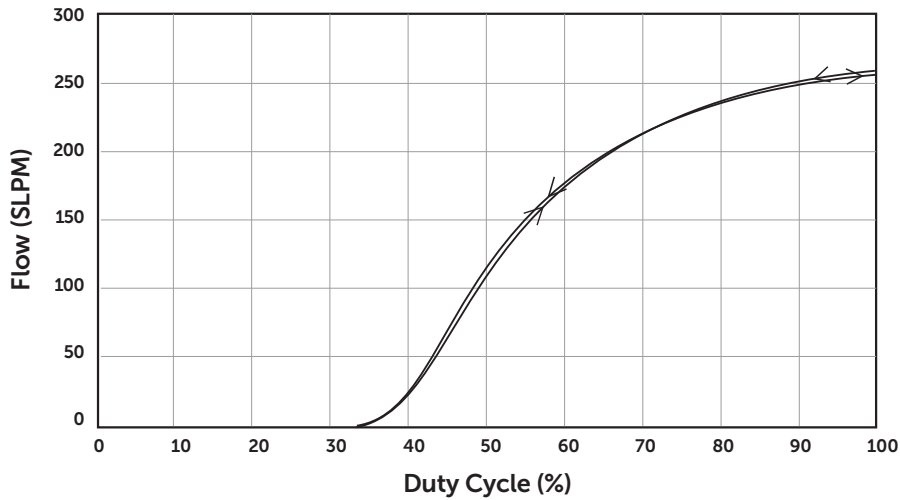

**Operating pressure:** 125 psig

**Orifice:** Ø5/64

**Notes:**

Given flow of air under maximum rated operating pressure and exhausting directly to atmosphere.

Flow values may vary depending on flowpath geometry following the valve.

**Repeatability:** <2.5%

**Hysteresis:** <5%

**Response Time:** 17 ms open @100%  
36 ms open @50%  
29 ms close

## Dimensions

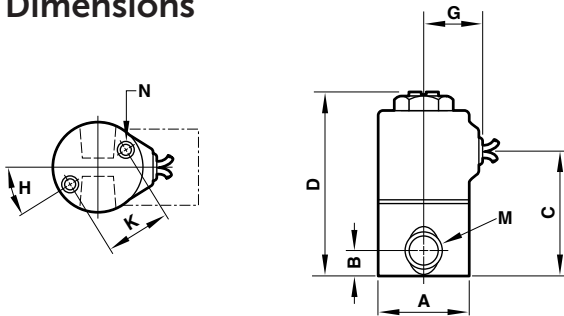

### Standard Valve

A	B	C	D	G	H	K	M	N
.99	.28	1.51	2.32	.64	32-	.73	1/8-27	#8-32
(25)	(7)	(38)	(59)	(16)	1/2°	(19)	NPTF	UNC x 1/4 MFT

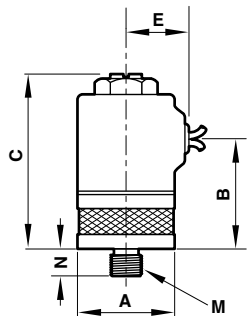

### Manifold Mount Valve

A	B	C	E	M	N
.99	1.26	1.98	.64	5/16 24	.25
(25)	(32)	(50)	(16)	UNF	(6)

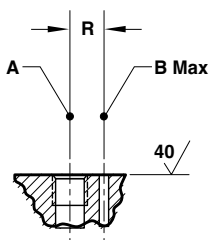

### Manifold Mount Interface

A	B	R
5/16 - 24 UNF-2B x .26 MFT	.09 (2)	.31 (8)

Dimensions in mm  
Projection/Third angle

